

Profile	Farbtemp. / CCT	Länge / Length x	Artikelnummer / Art. no.
1416	827	2m	1007499
1416	830	2m	1007497
1422	827	2m	1007503
1422	830	2m	1007501
1416	827	3m	1007500
1416	830	3m	1007498
1422	827	3m	1007504
1422	830	3m	1007502

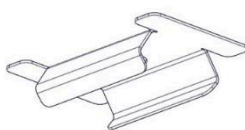

Länge / Length x	Stück / Pcs. (Inklusive / included)
2m	4
3m	5

Standardset			Optional / optionally	

Profile	Art. Nr. Standardset	Stück / Pcs.	Art. Nr. optional / optionally	Stück / Pcs.
1416	1007505	2	1005733	1
1422	1007506	2	1005729	1



Artikelnummer / Art. no. 1006880



Artikelnummer / Art. no. 1006313



Artikelnummer / Art. no. 1007599



Artikelnummer / Art. no. 1006314

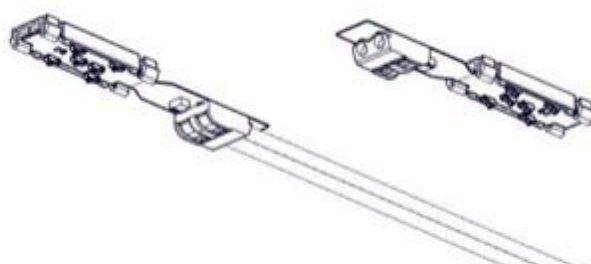

Artikelnummer / Art. no. 1007411



Leistung / Power DIP-Switch

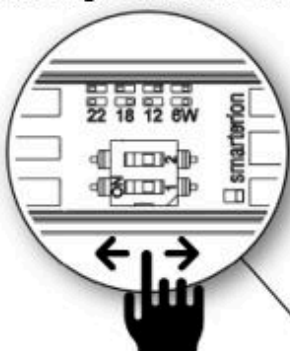

W	X max. (Maximale Länge mit einer Einspeisung)
6	25m
12	20m
18	15m
22	11m

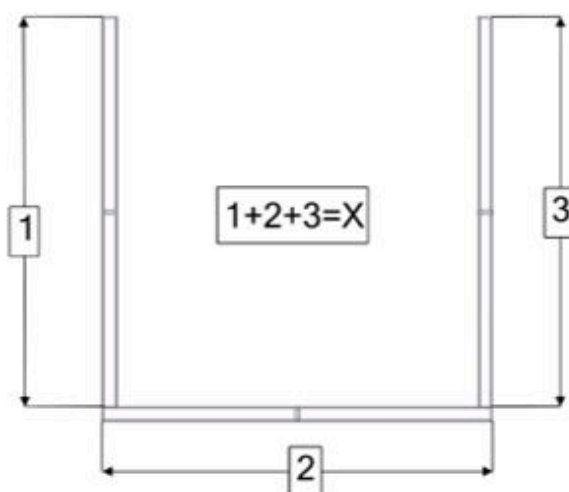
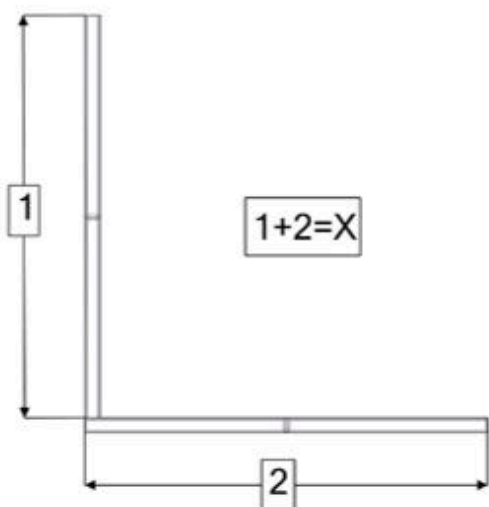
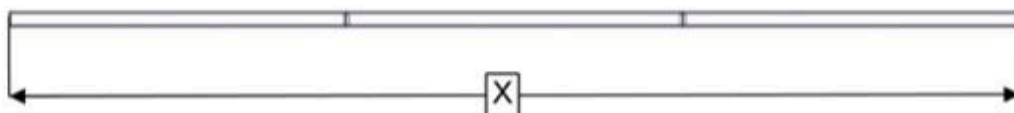



Profil optimal zuschneiden / cut profile optimal

50mm	3-5mm
100mm	
150mm	
200mm	
...	

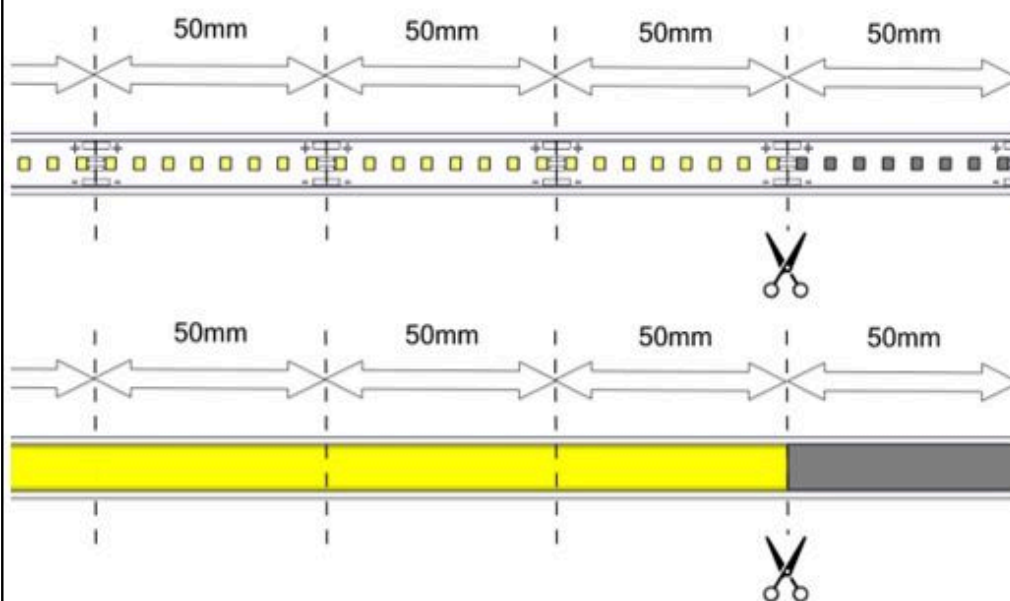

Profilzuschnitt auf Mass / cut profile to size

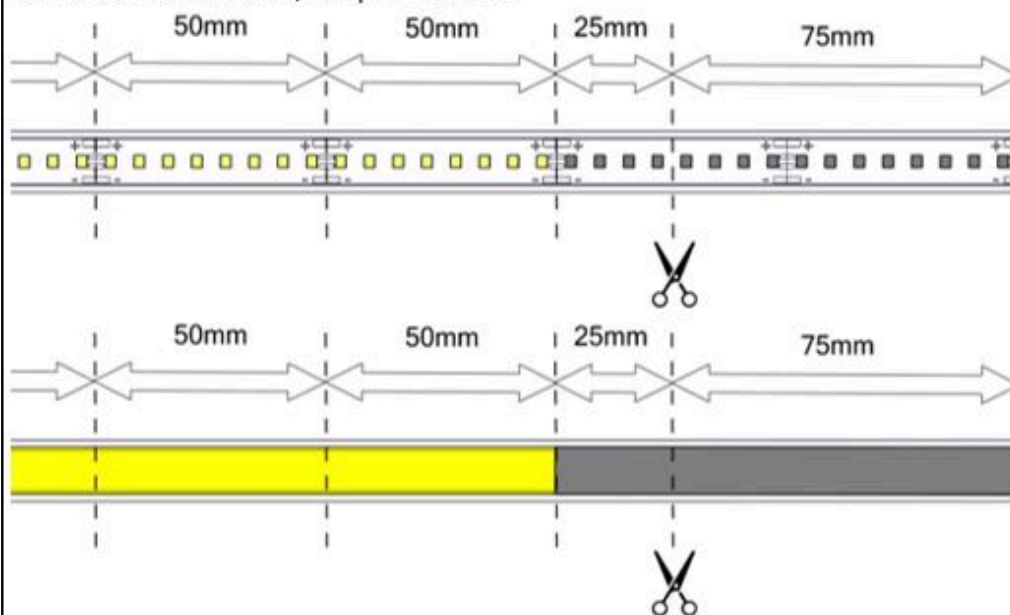

SCHWEIZER LED KOMPETENZ

An exploded view diagram of the LED strip assembly. The components are labeled as follows:

- 1**: The main LED strip, shown as a long, thin, rectangular profile.
- 2**: A mounting bracket or clip, shown as a small, L-shaped component with a central slot.
- 3**: A small, rectangular component, likely a connector or end cap, shown as a small, rectangular block.
- 4**: A small, rectangular component, likely a connector or end cap, shown as a small, rectangular block.

The diagram illustrates how these components are assembled onto the LED strip. The mounting bracket (2) is shown being inserted into the top of the strip (1). The small rectangular components (3 and 4) are shown being inserted into the ends of the strip (1).

A 3D perspective view of a long, thin, rectangular component, likely a beam or rail. A label '1' with a pointer indicates the top surface of the component.



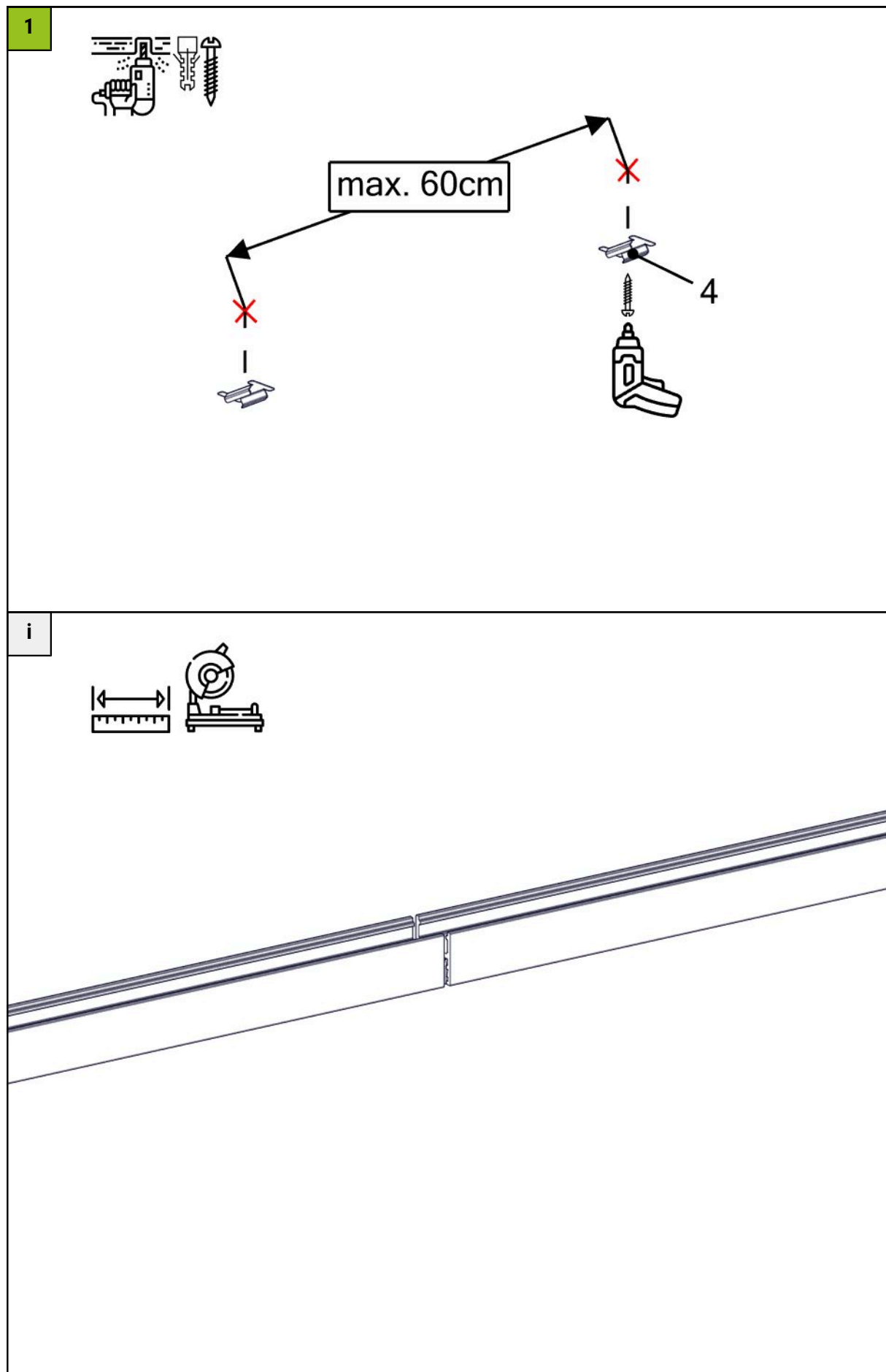

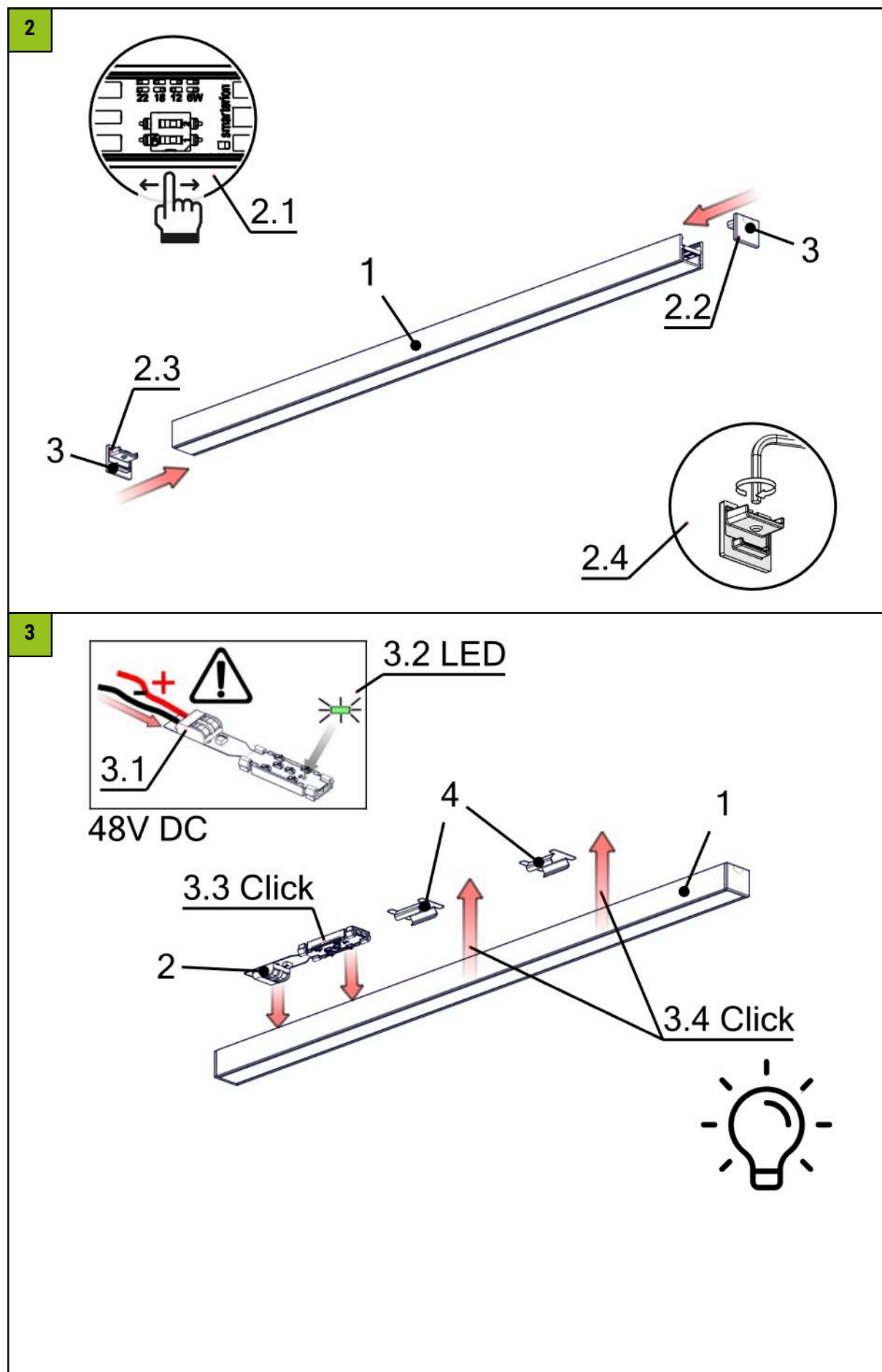

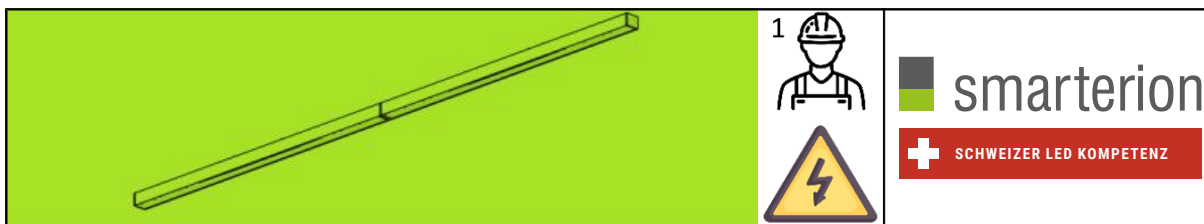

smarterion

SCHWEIZER LED KOMPETENZ

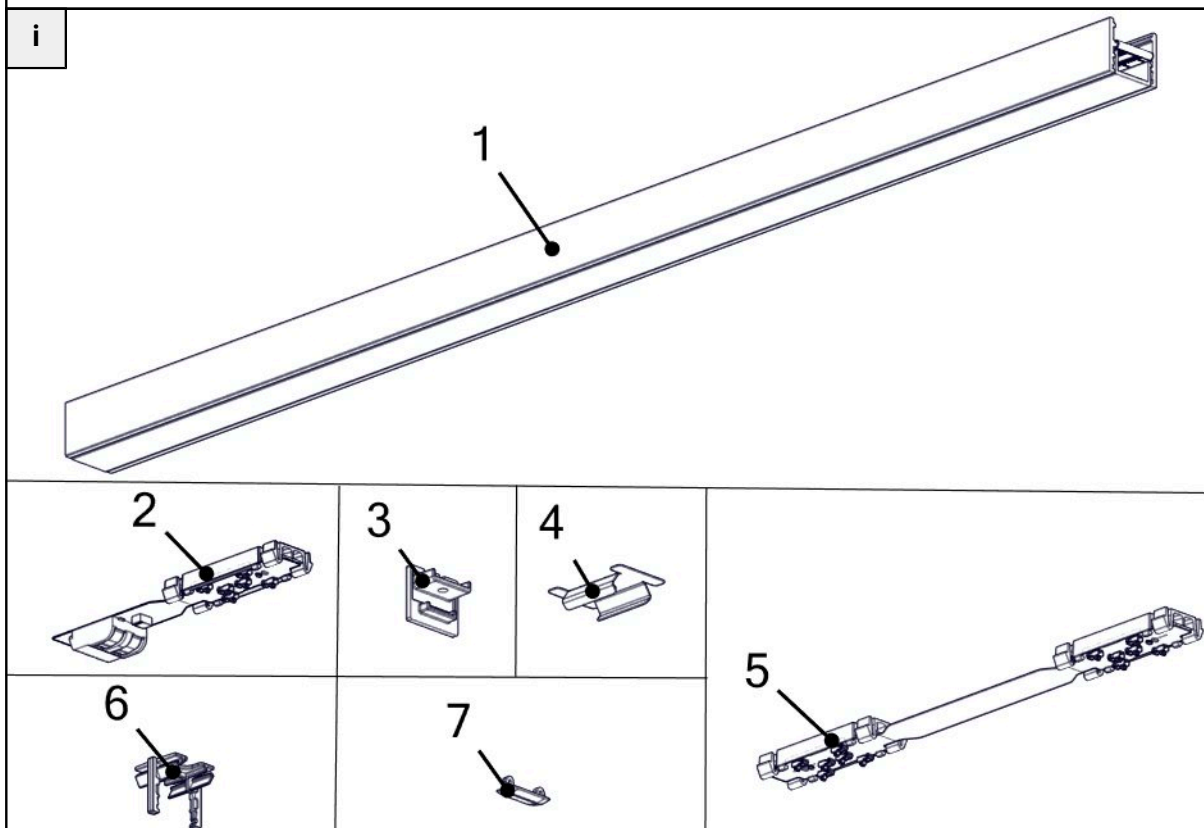
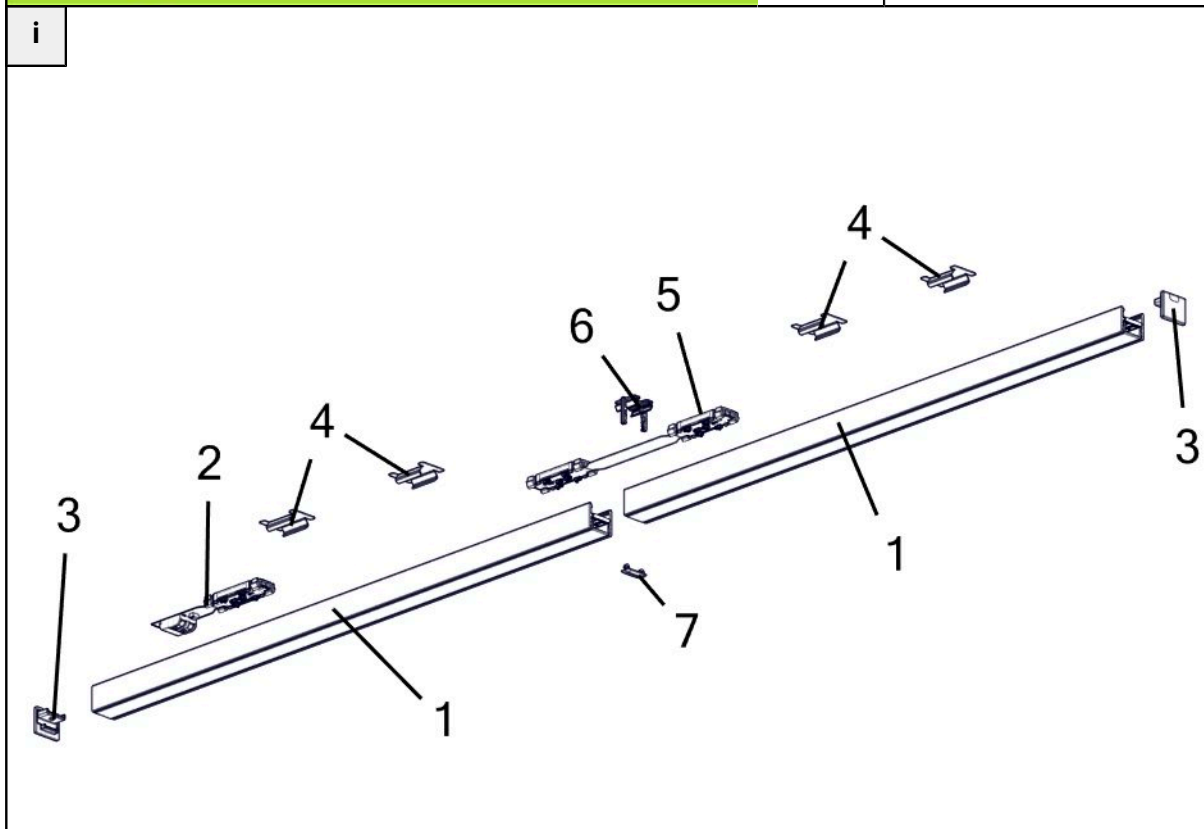

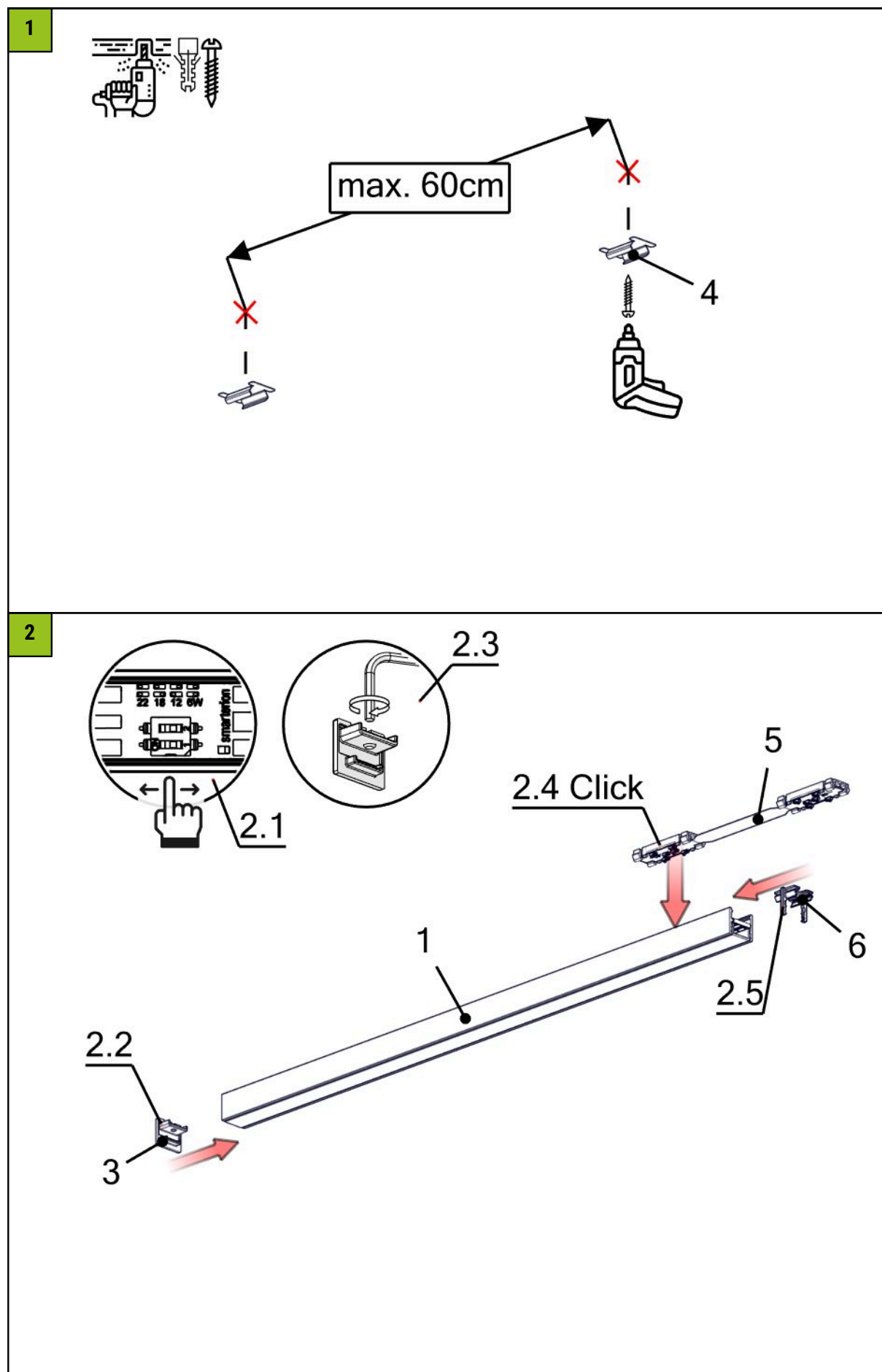

3

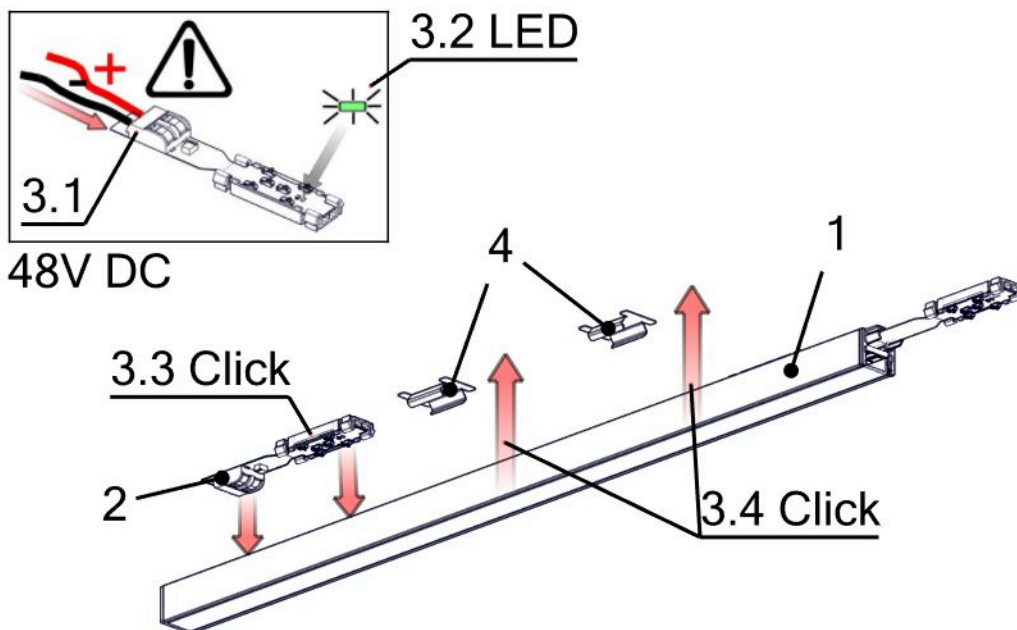

i

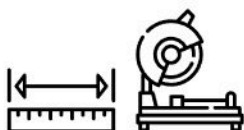

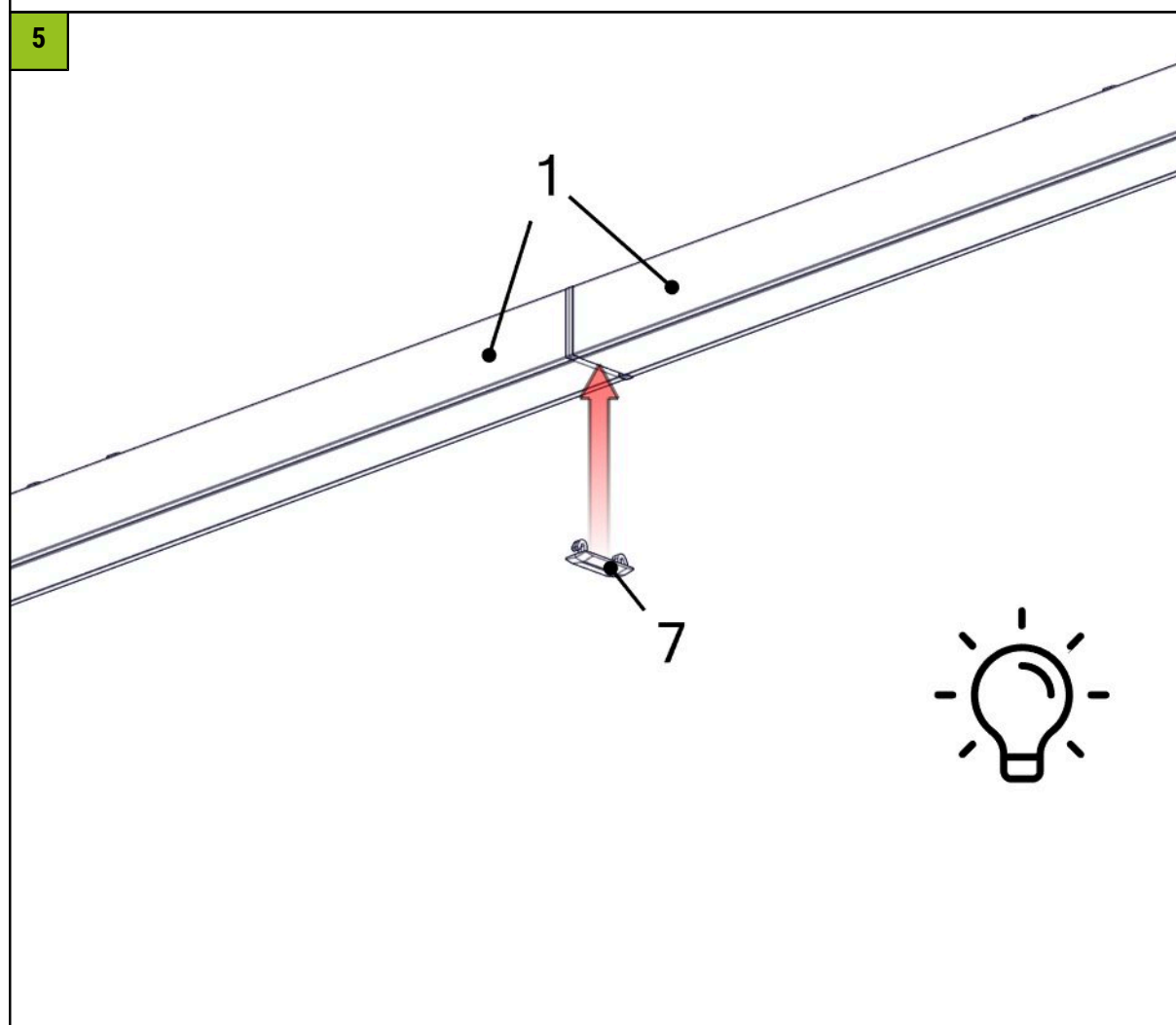
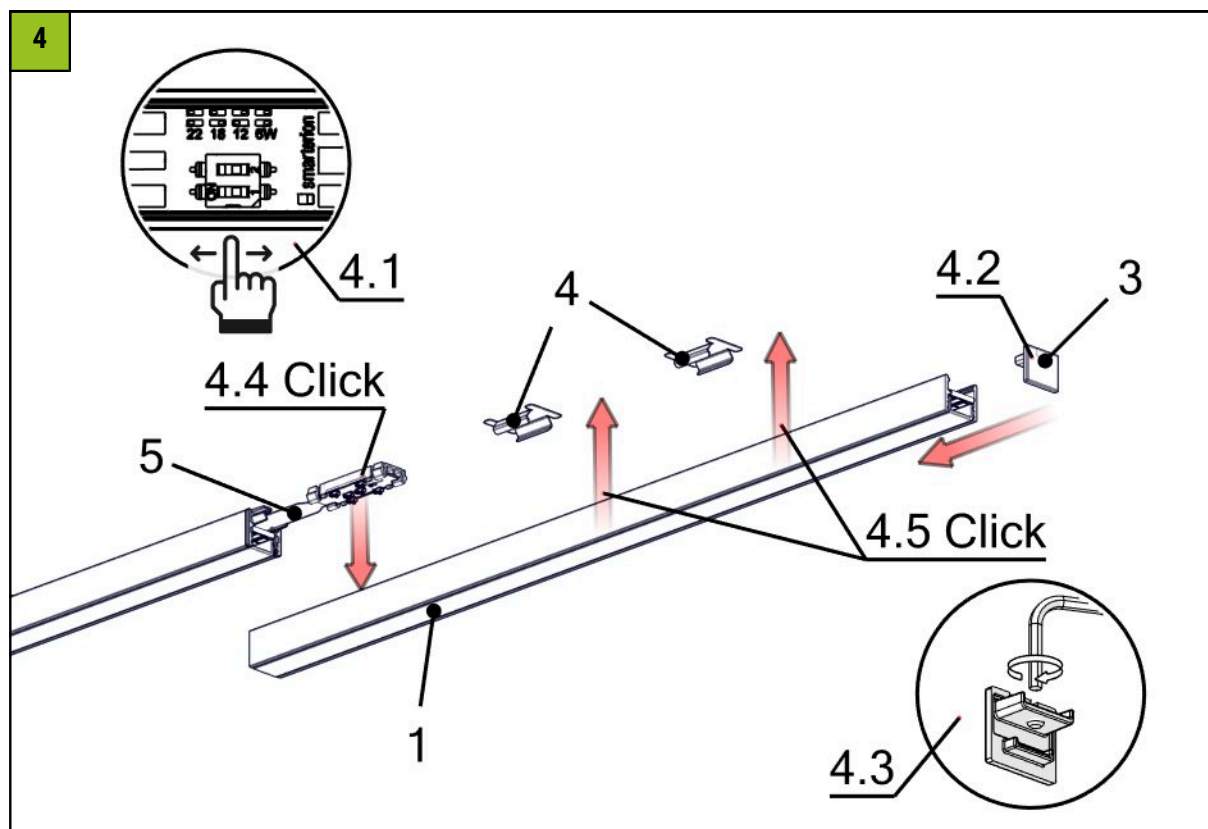

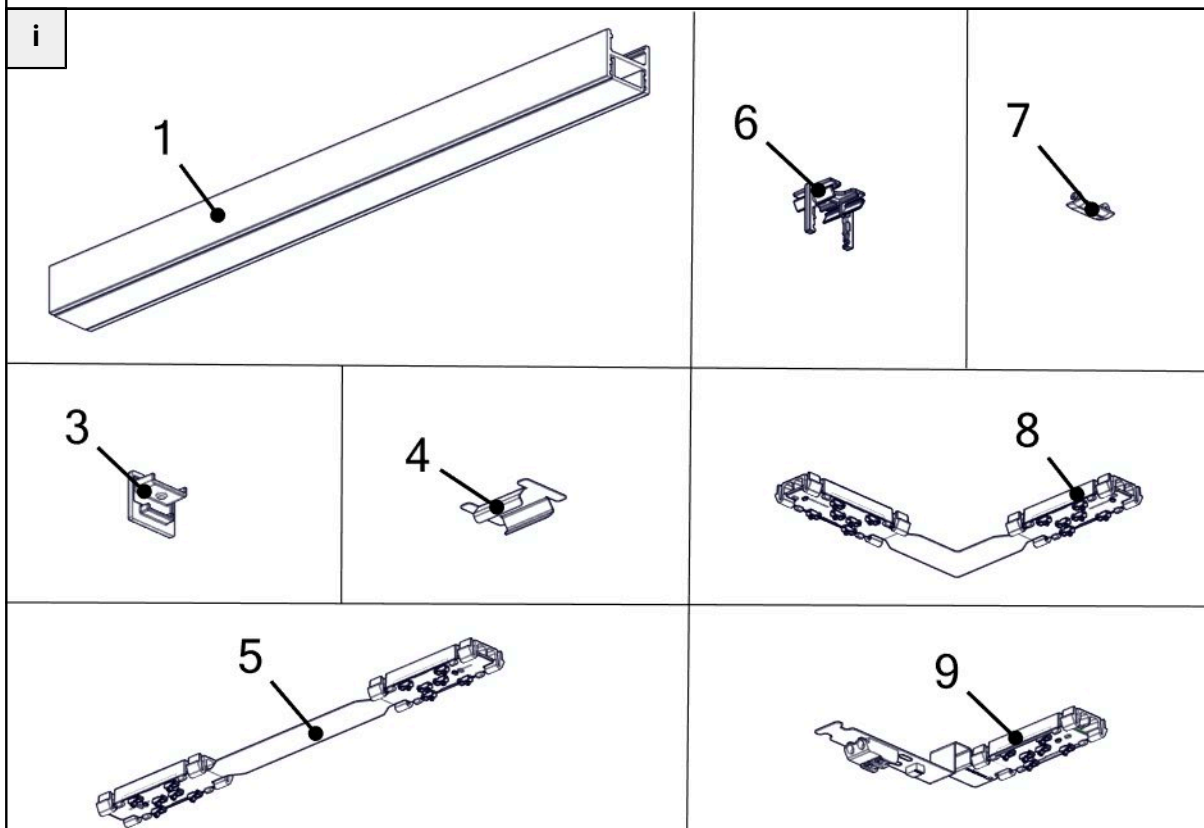
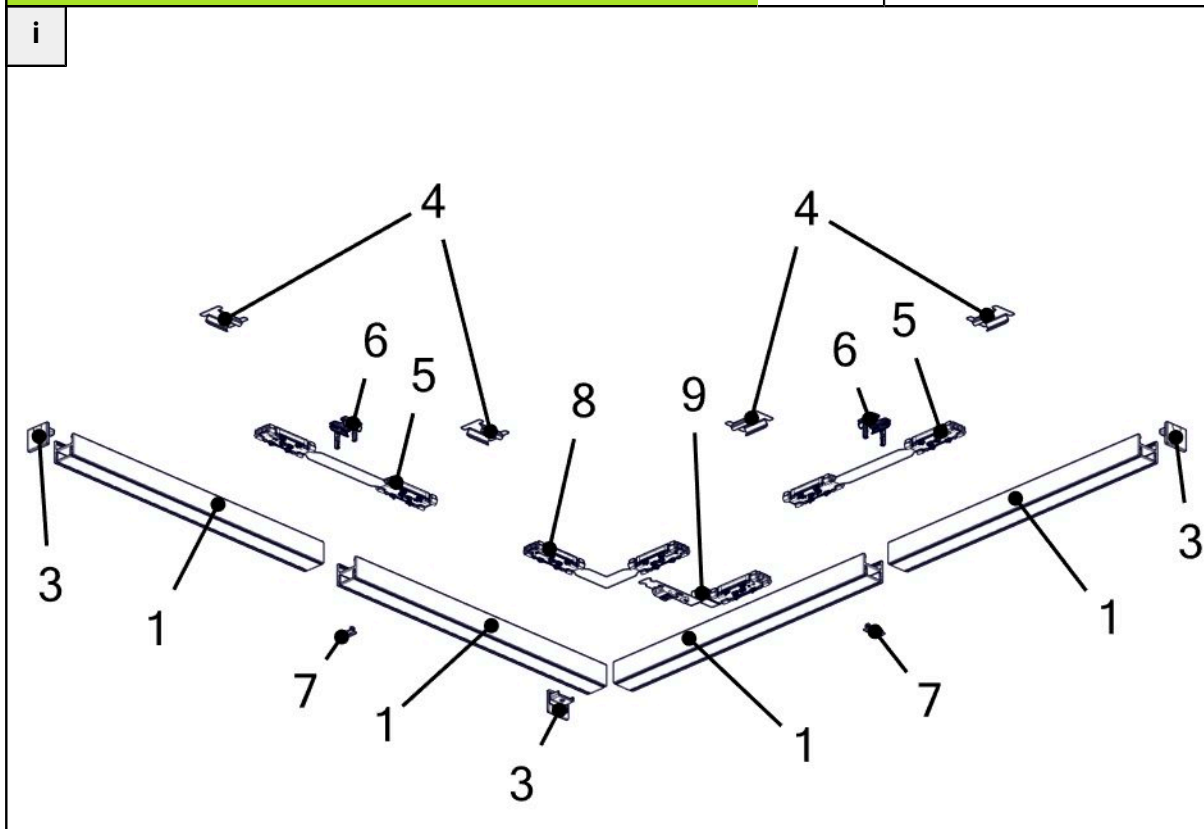
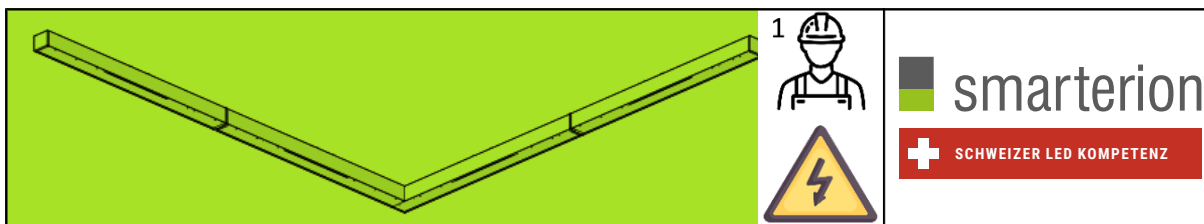

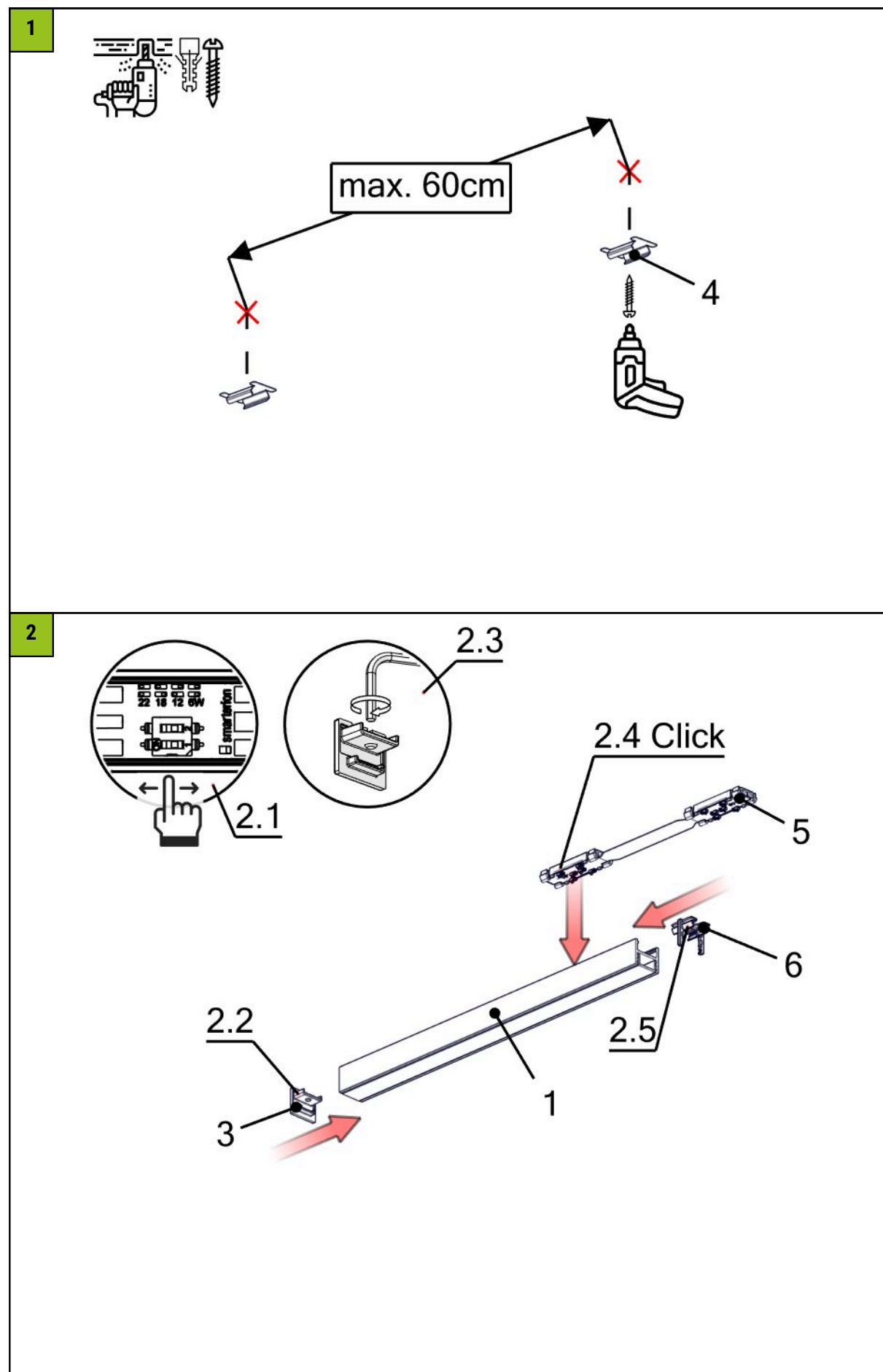

3

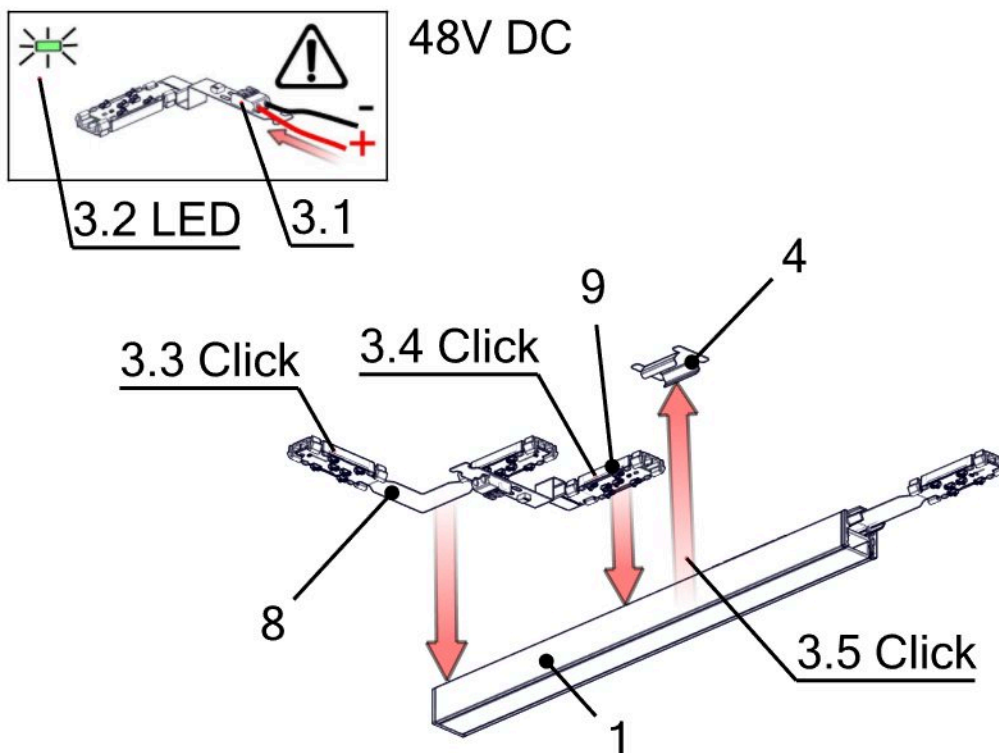

i

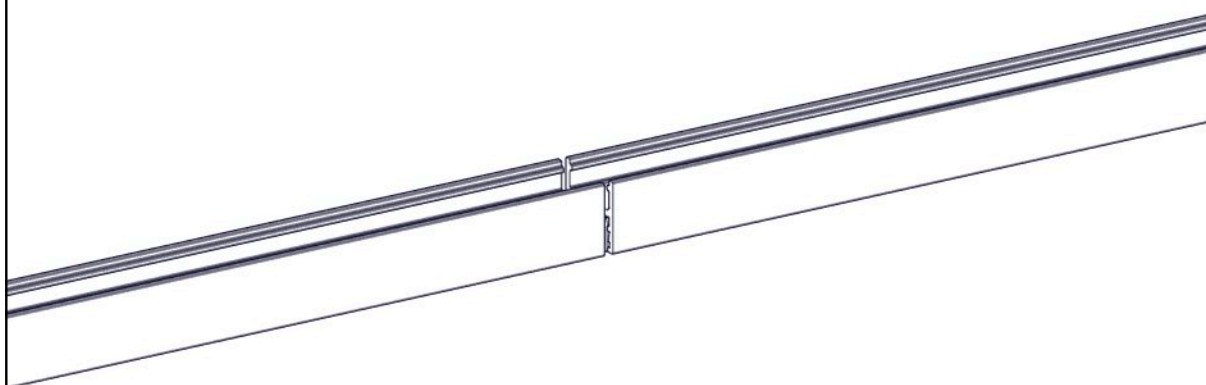
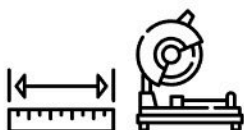

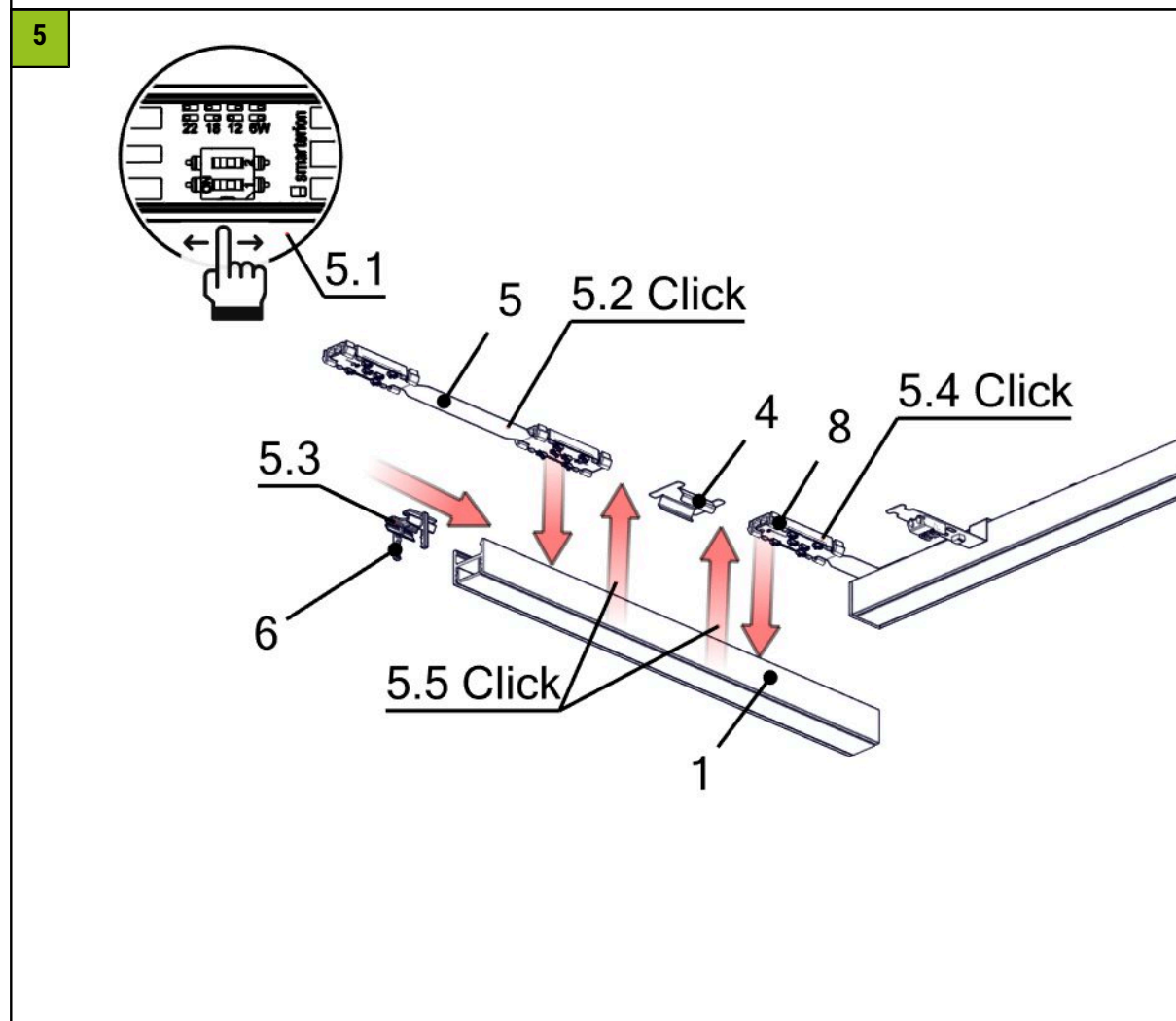
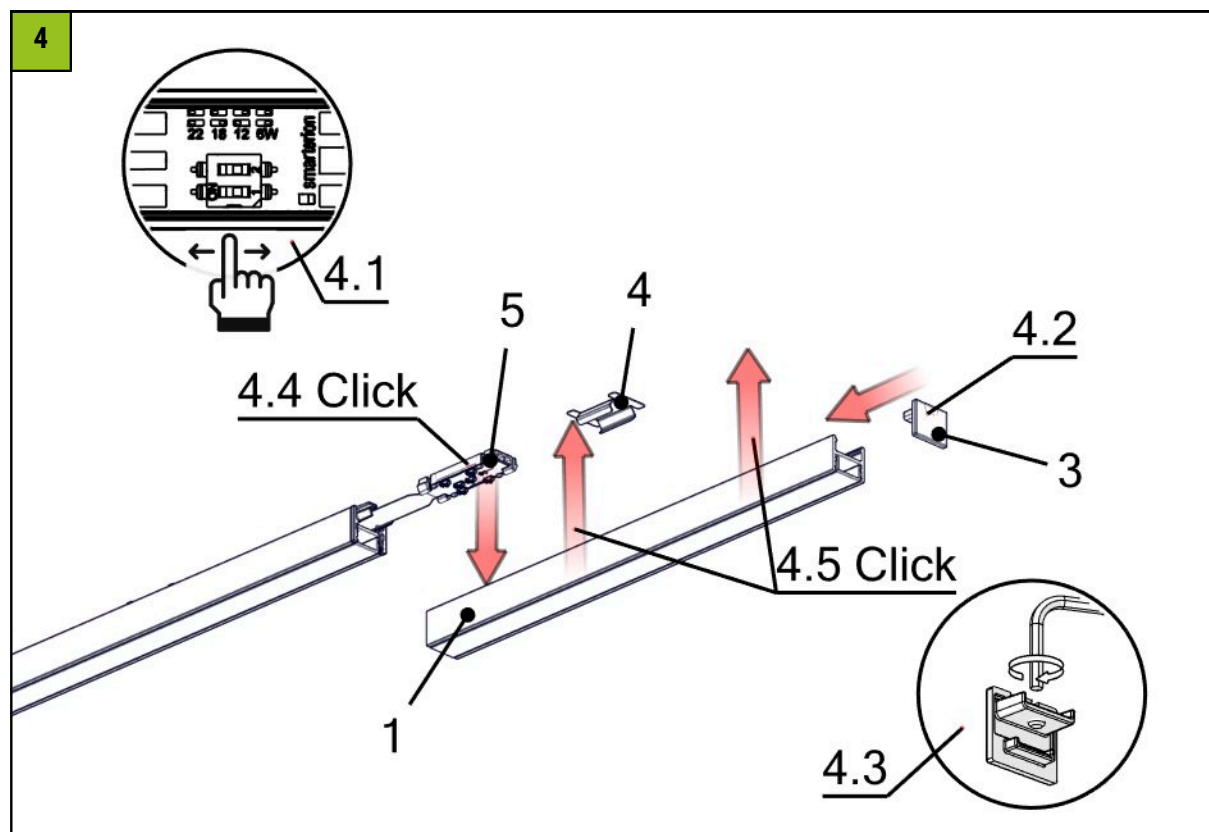

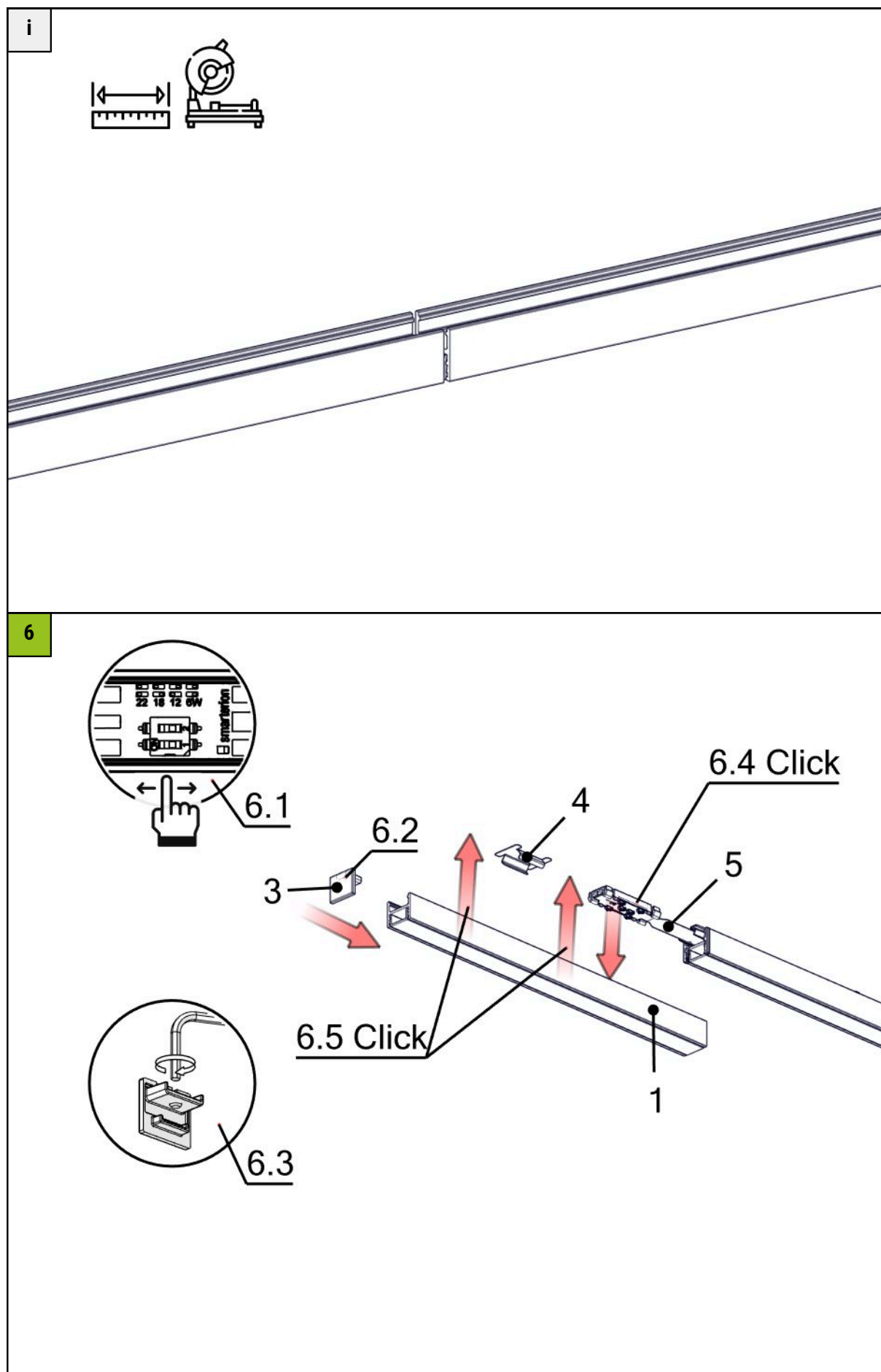

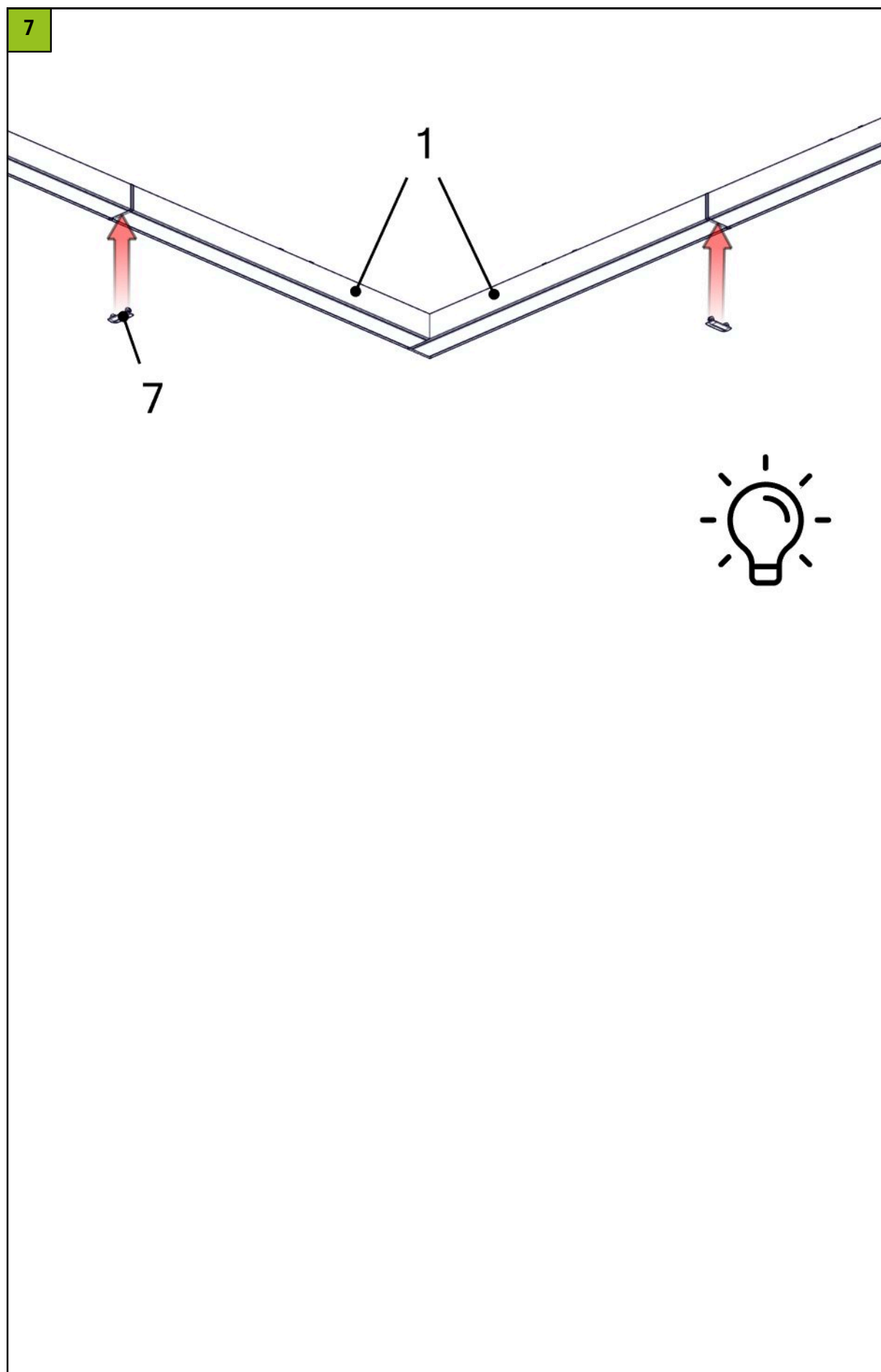

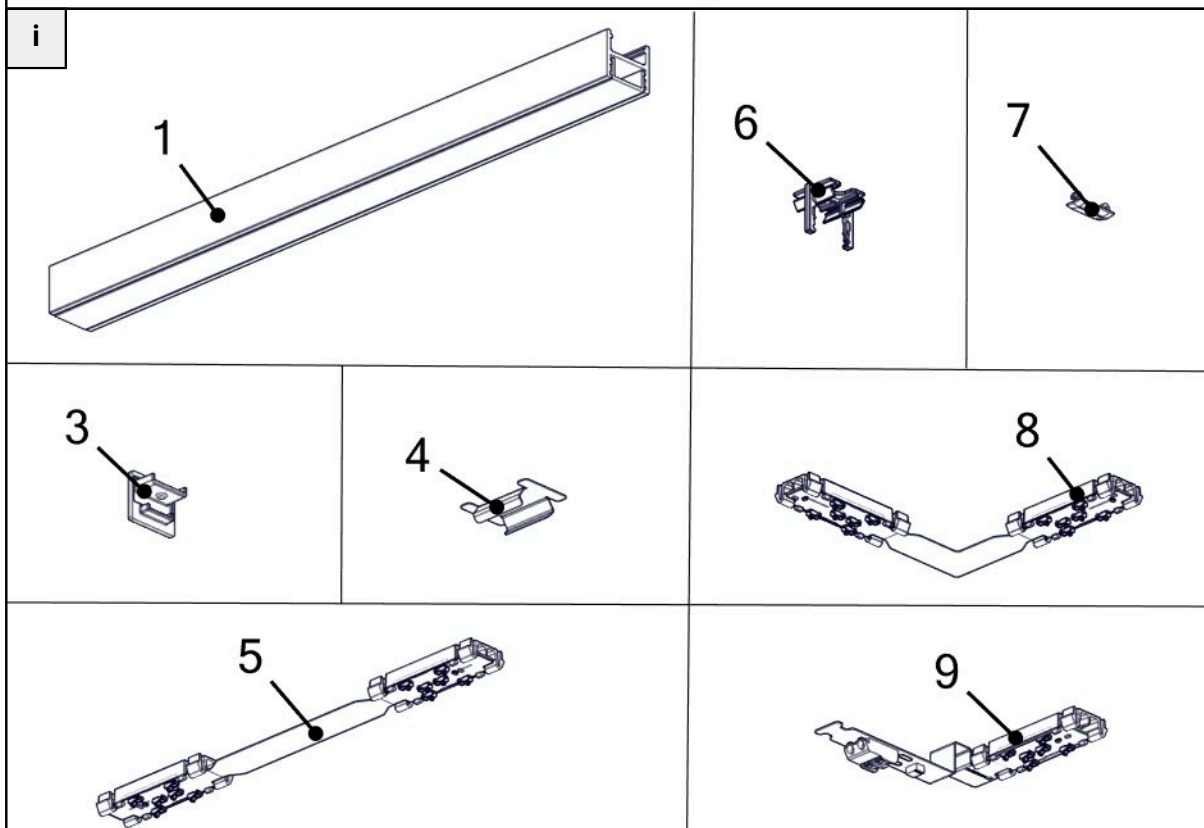
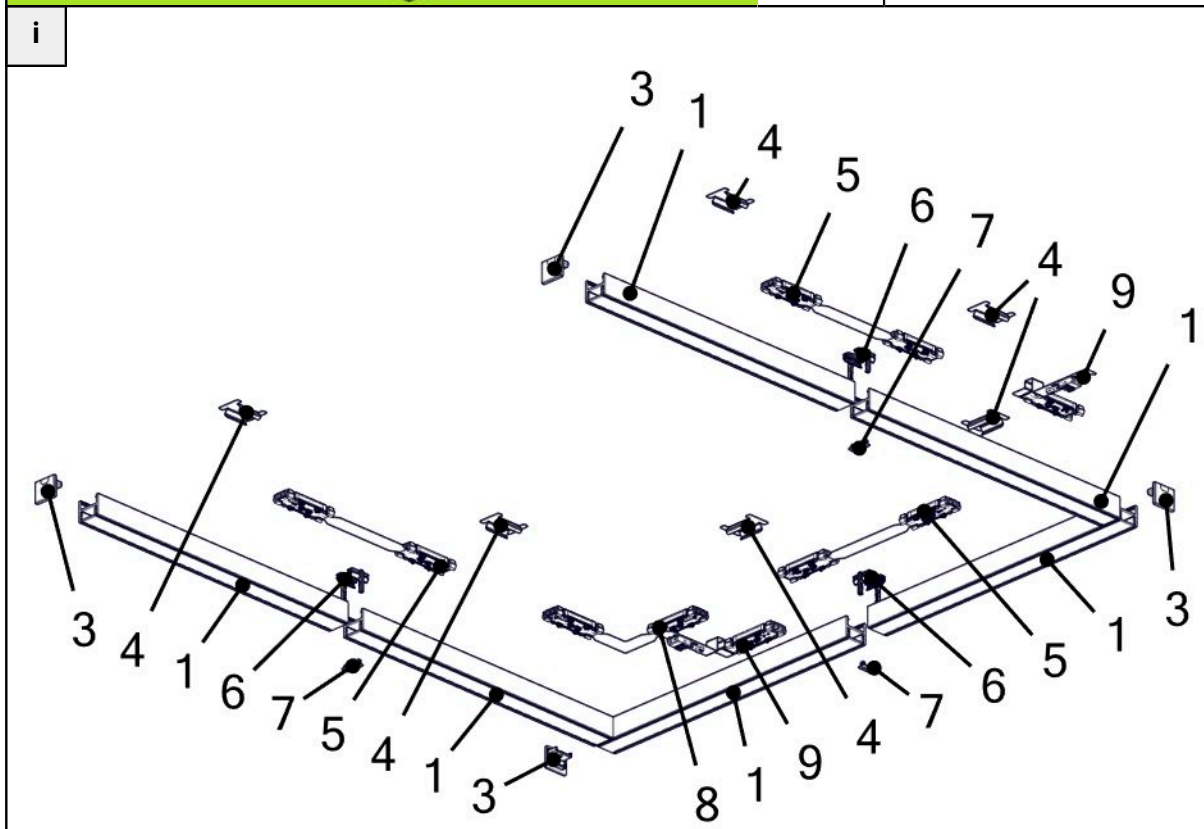
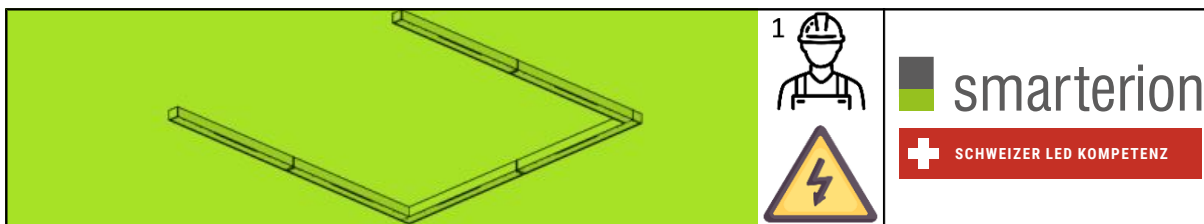

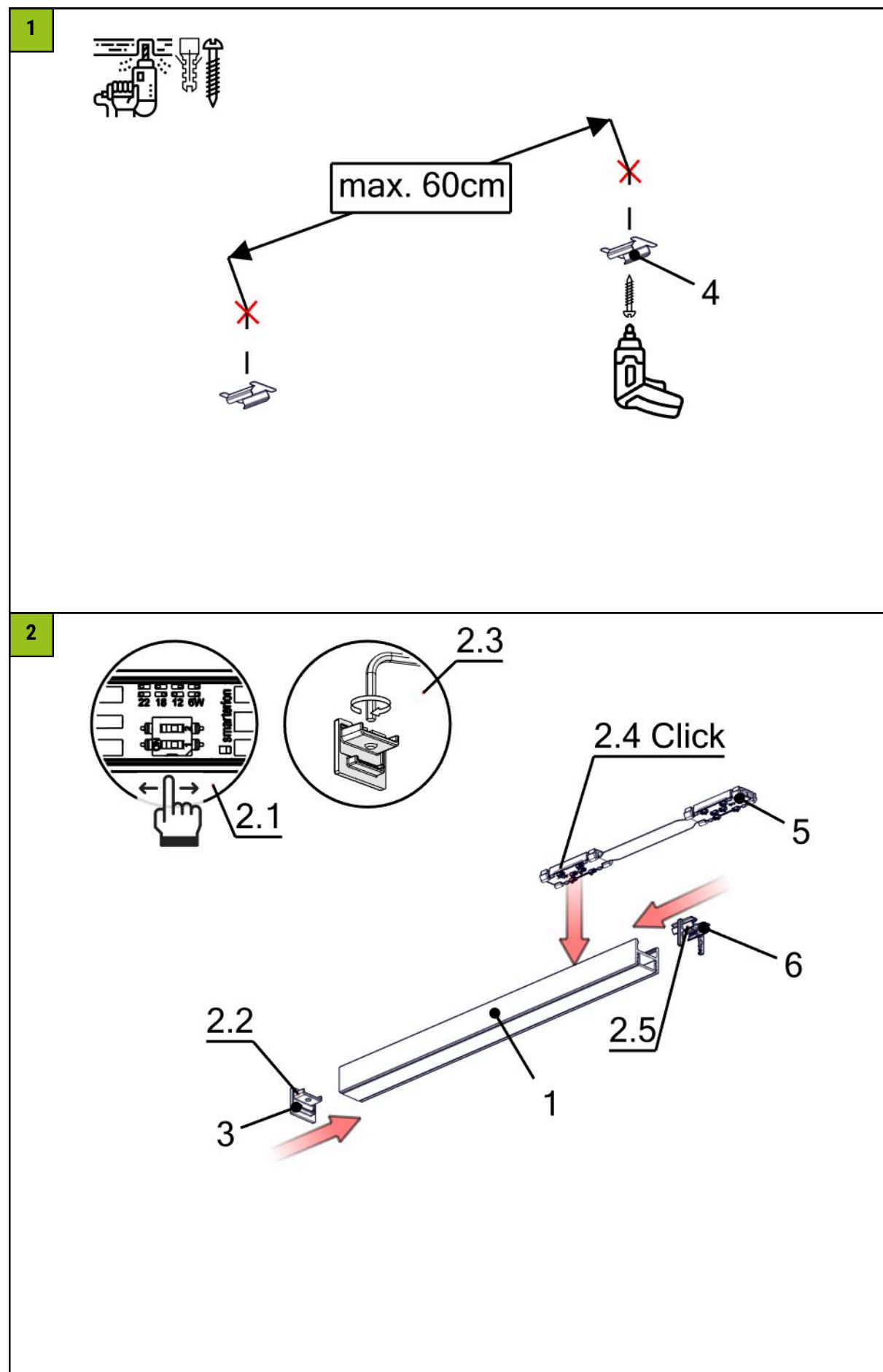

3

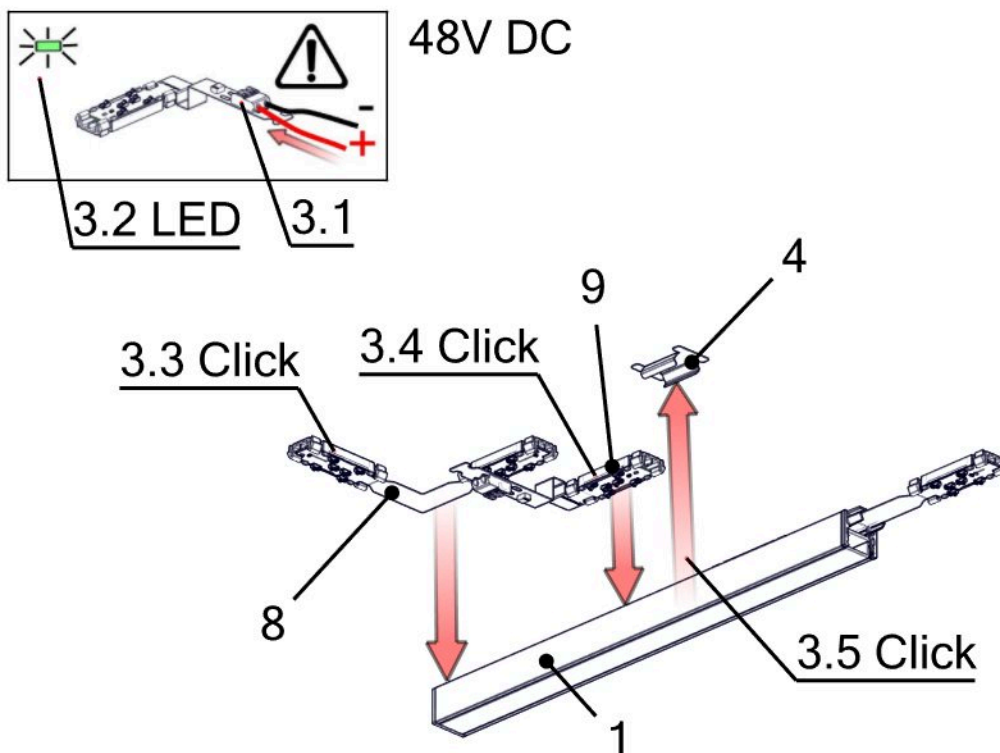

i

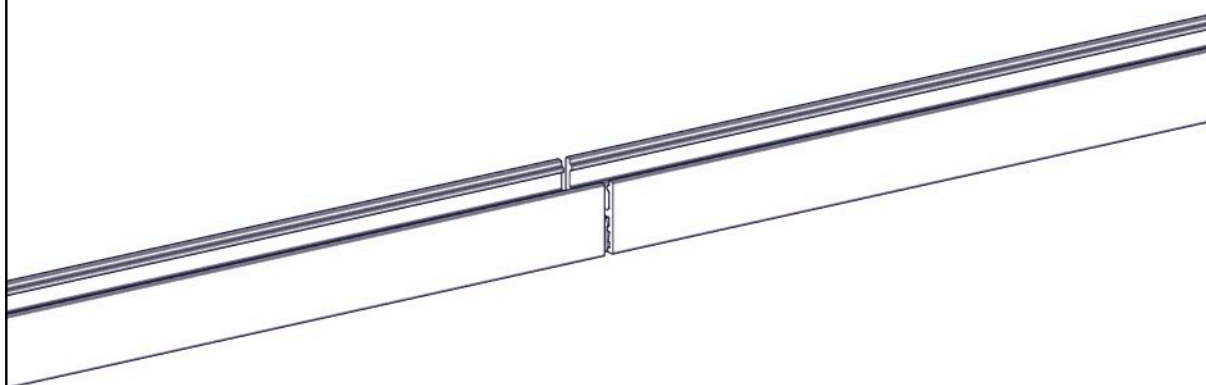
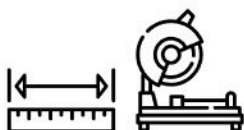

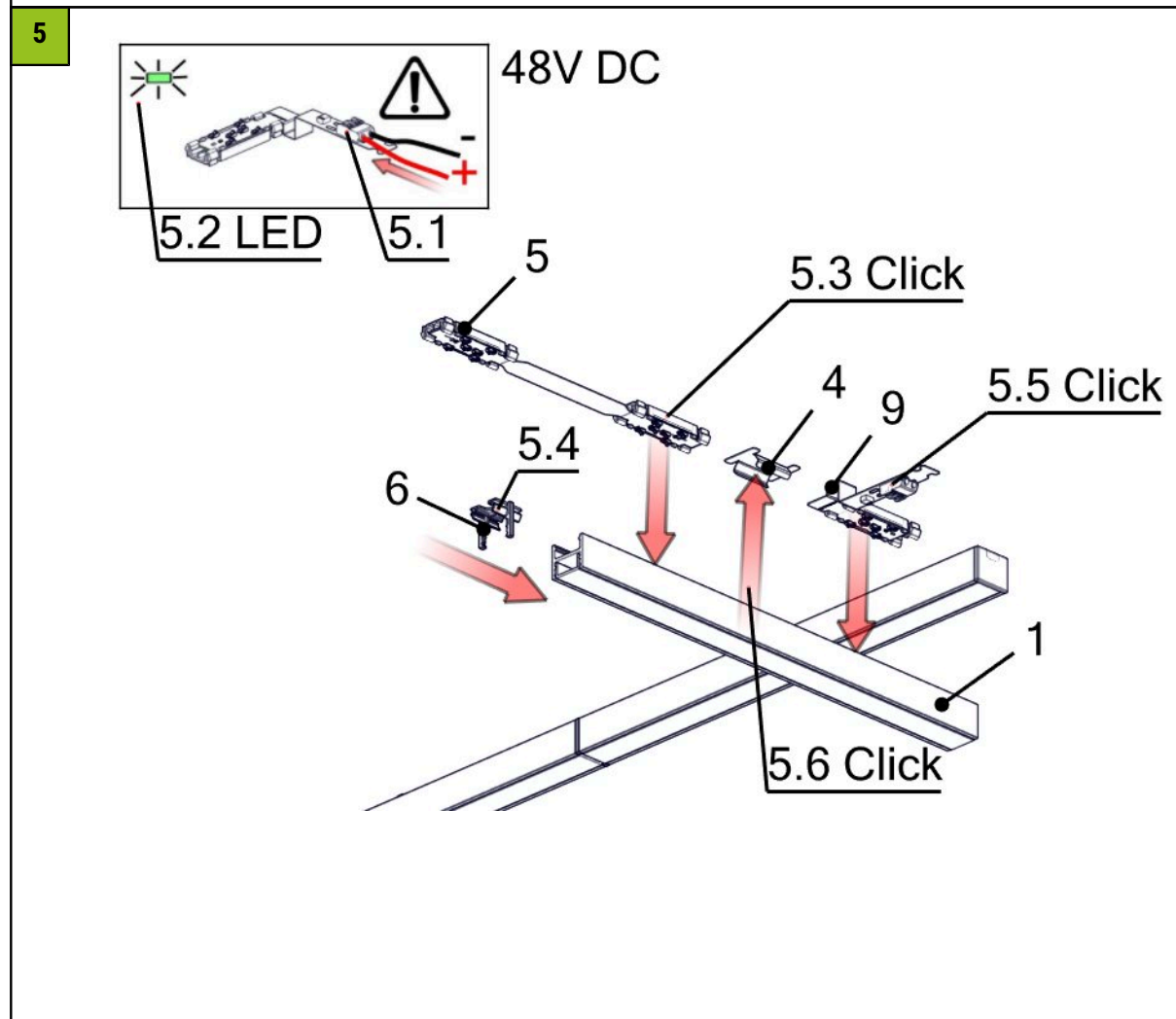
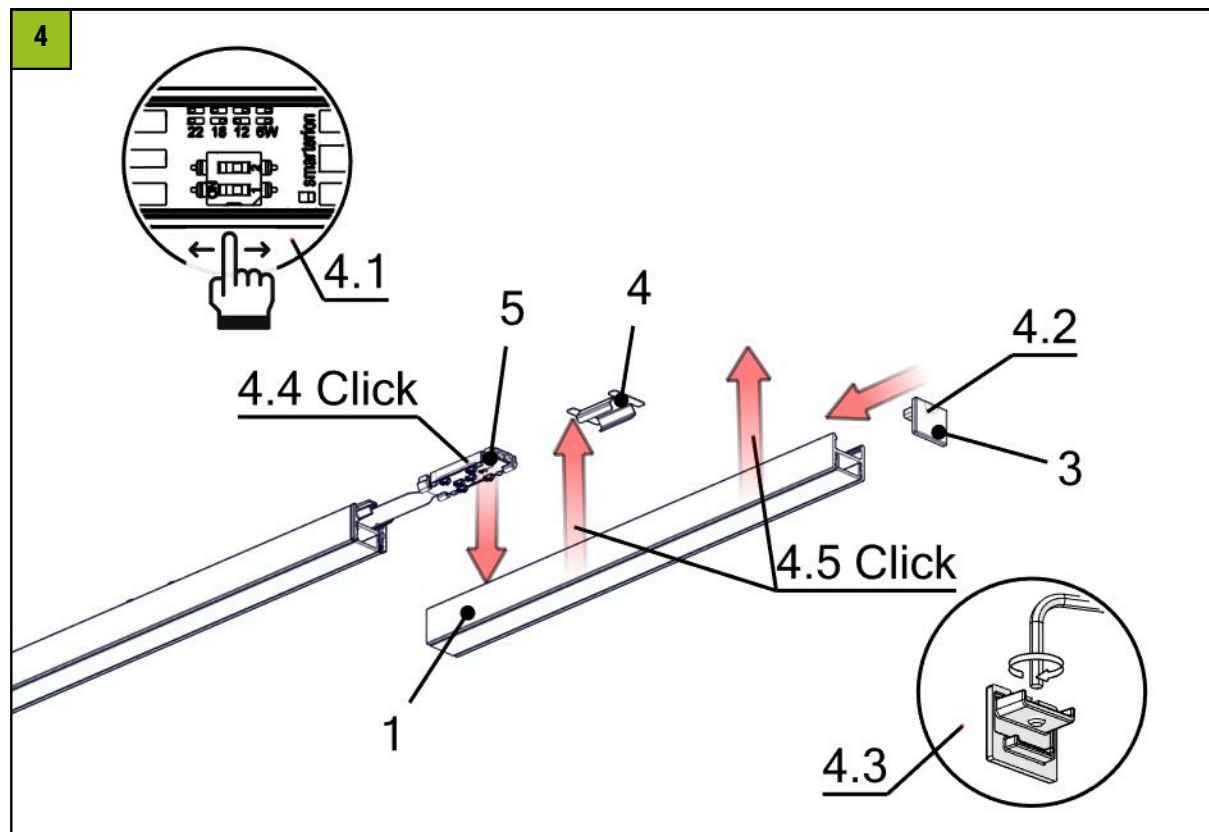

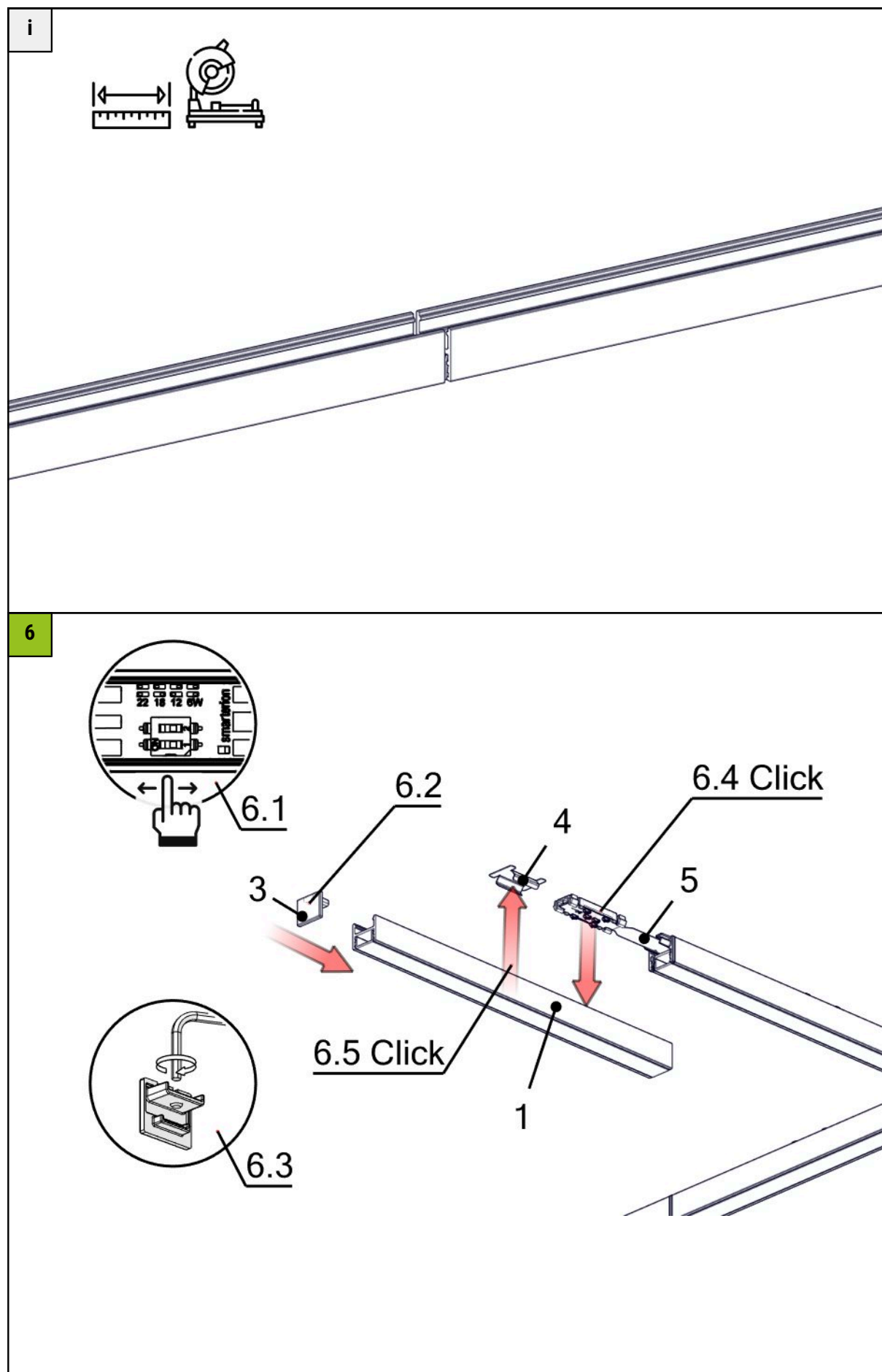

7

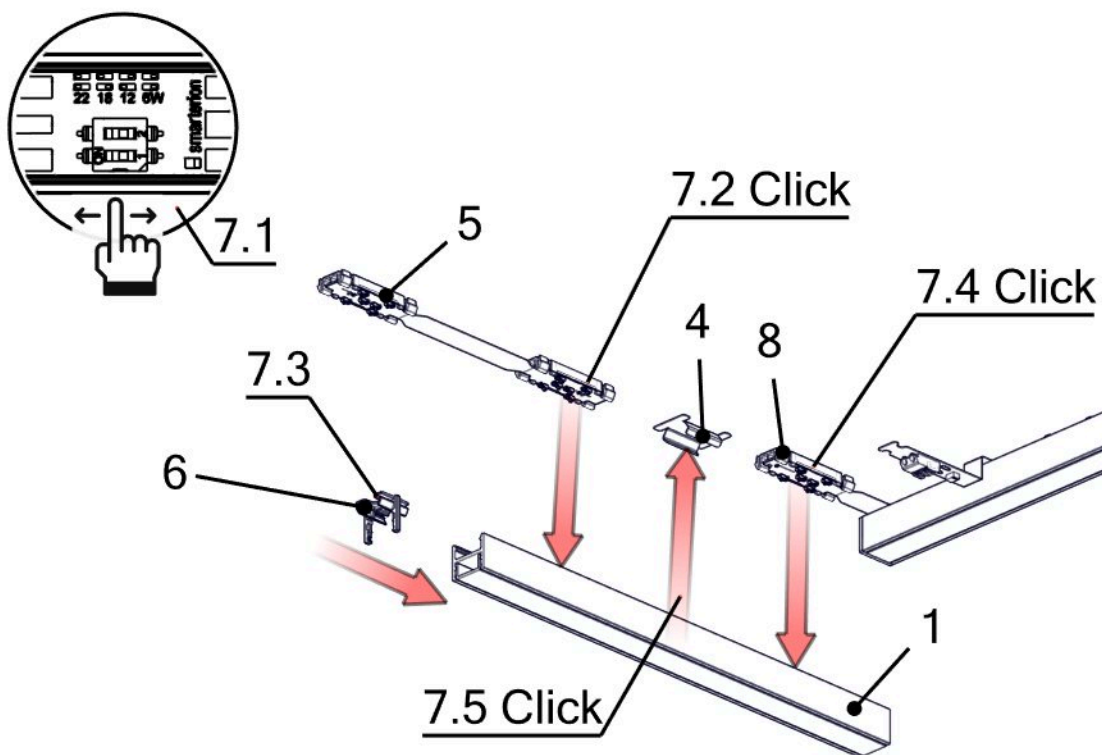

8

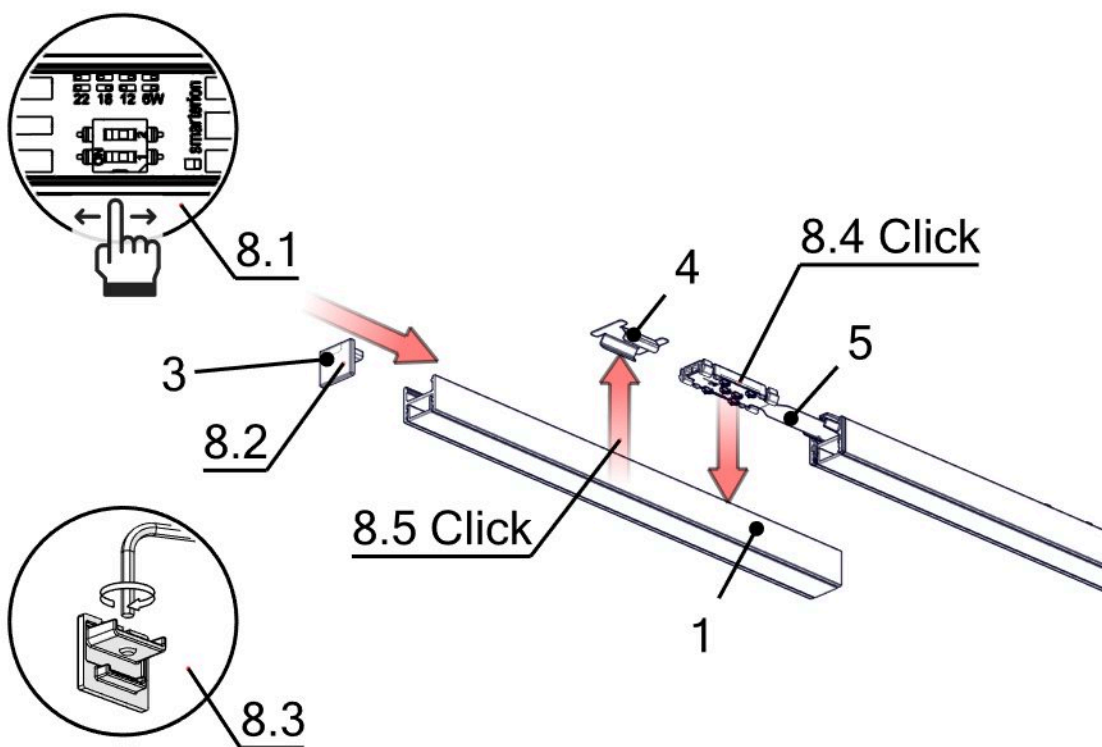

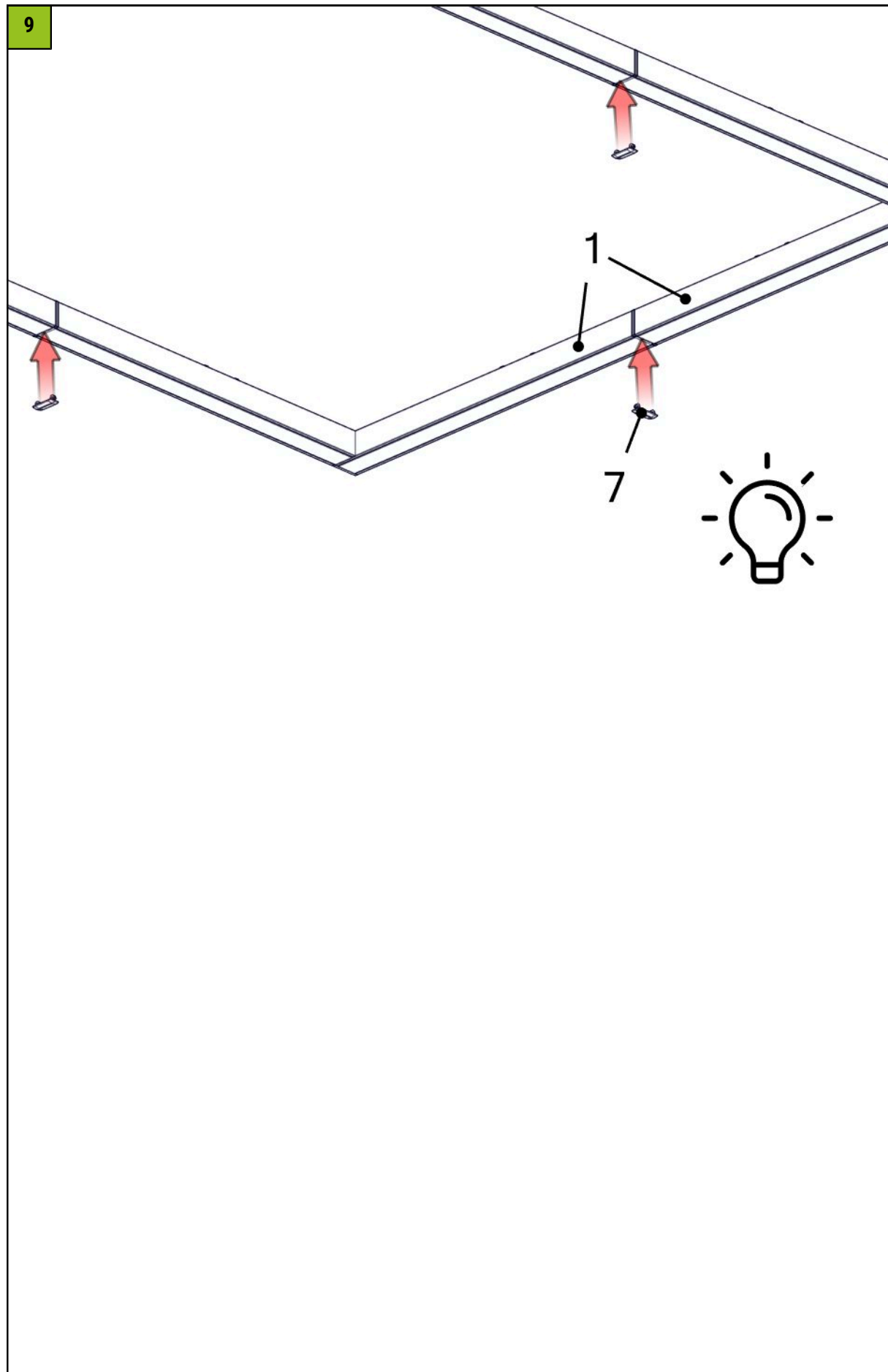

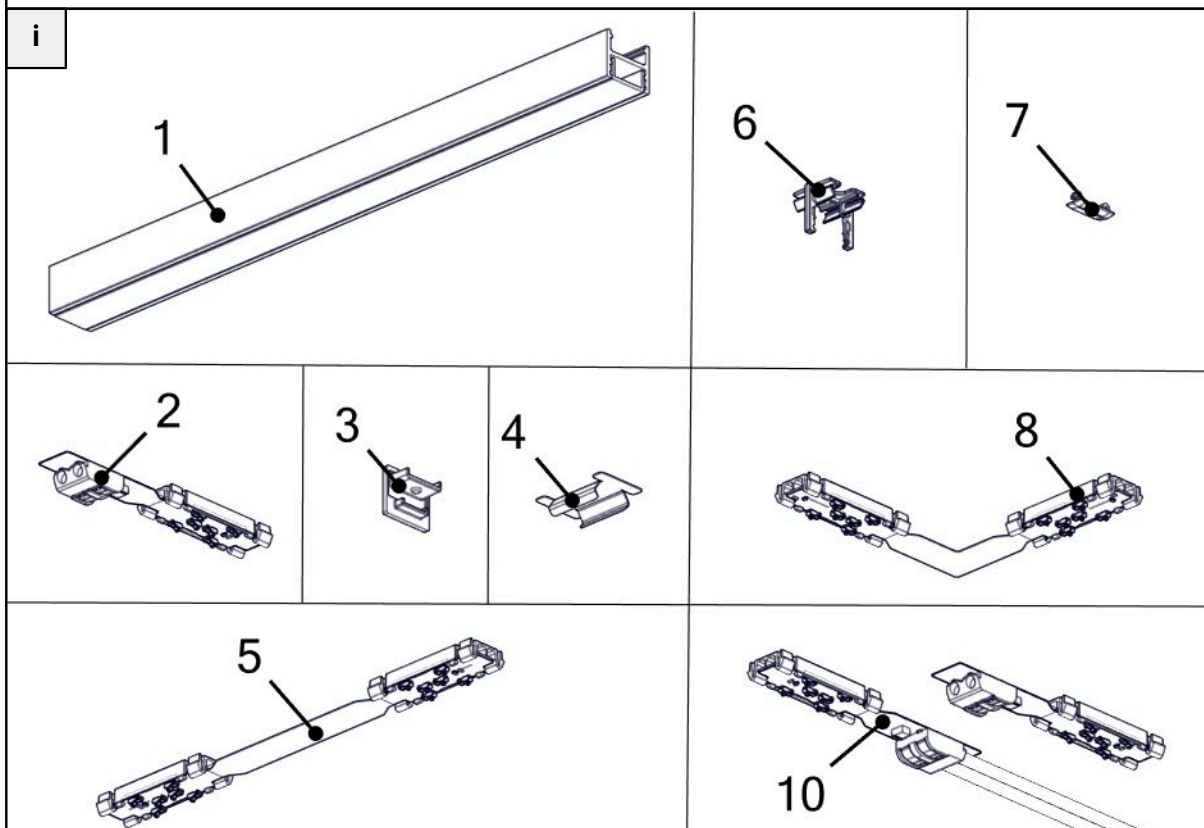
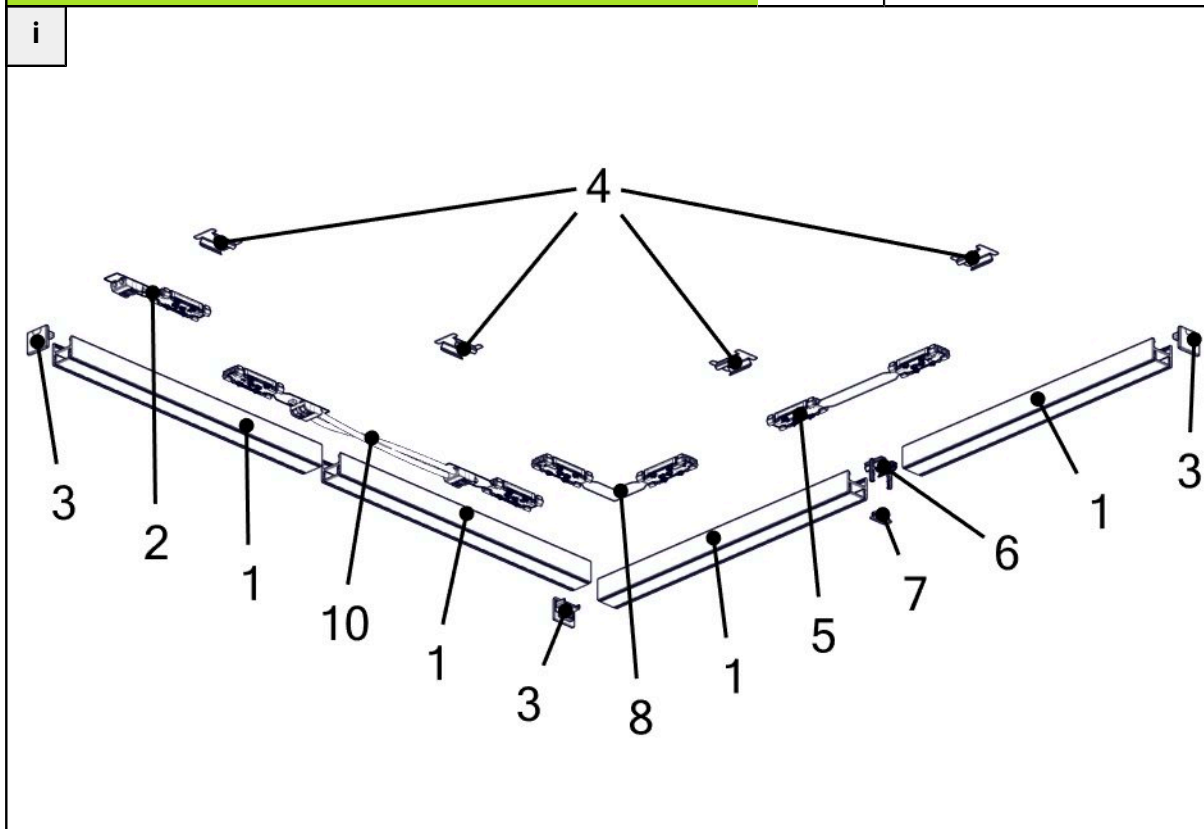
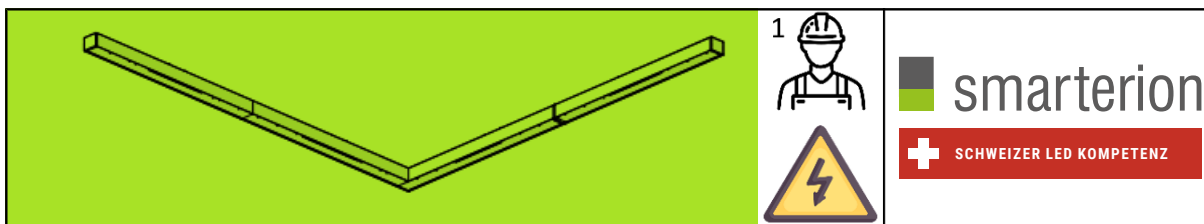

1

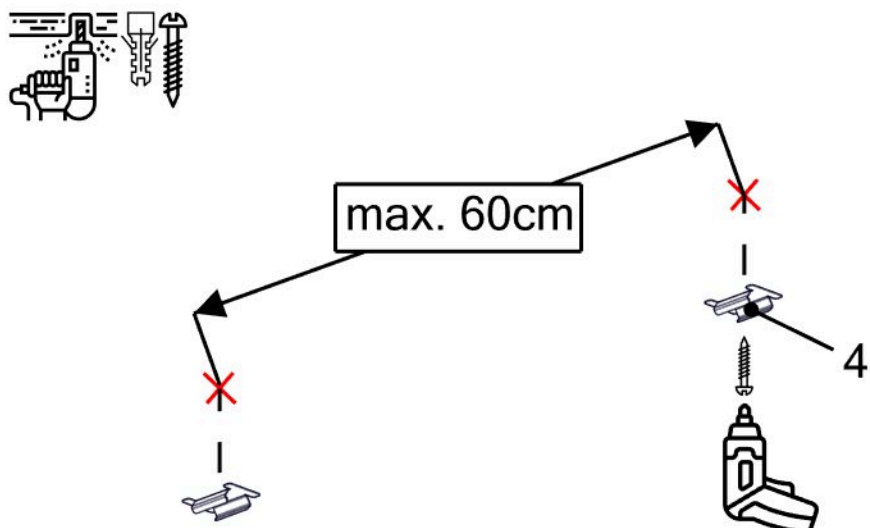

2

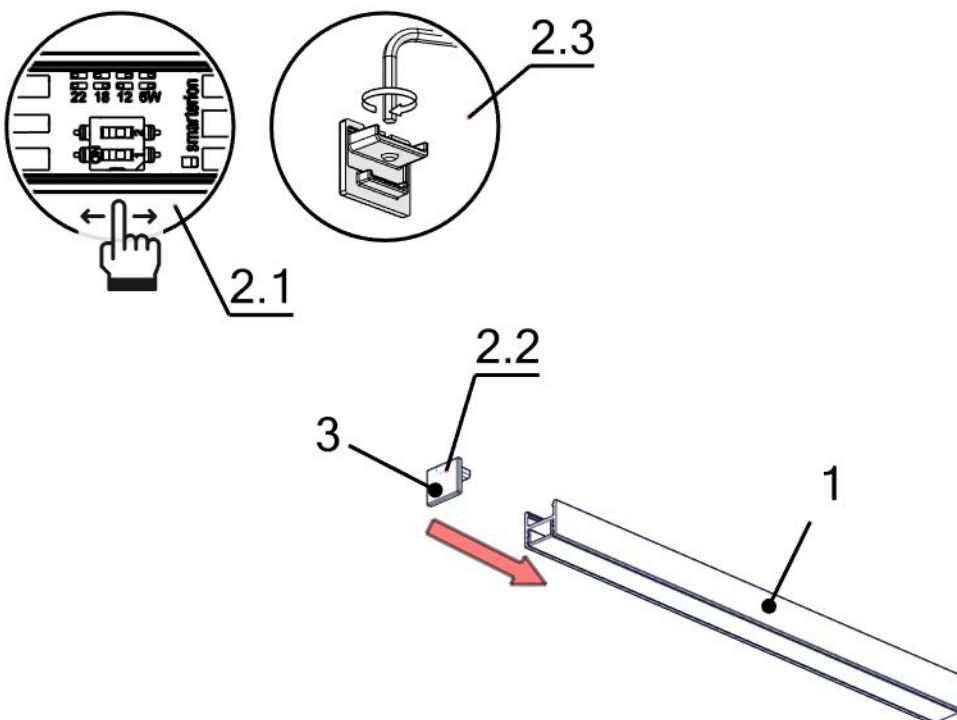

3

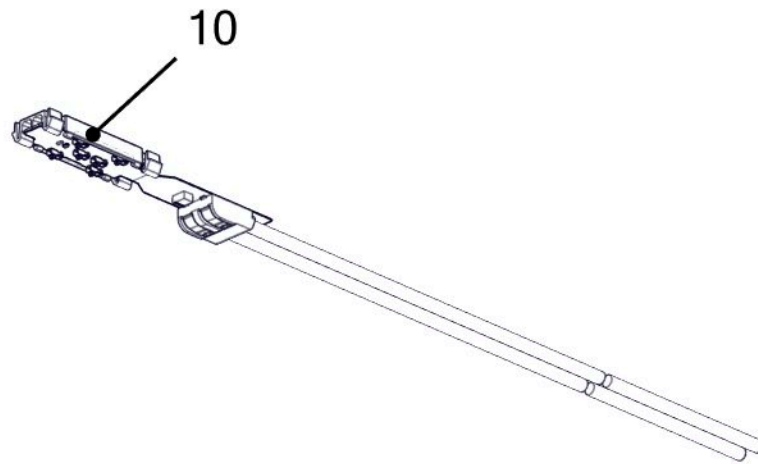
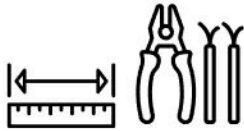

4

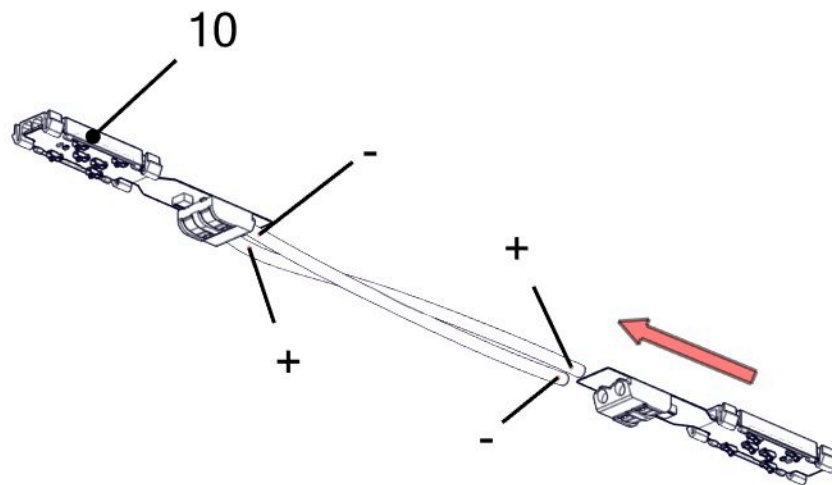

5

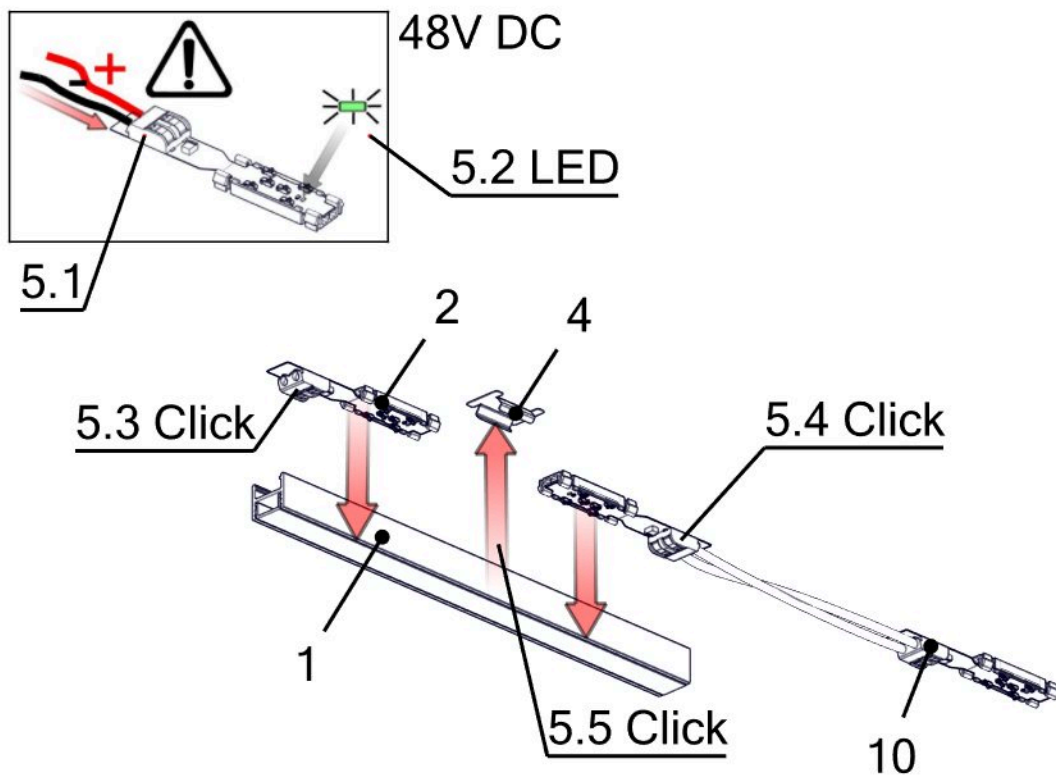

i

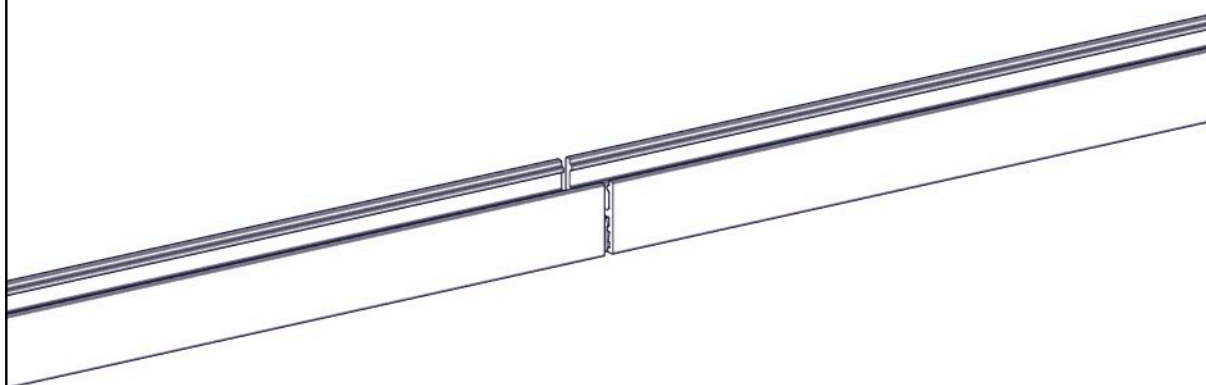
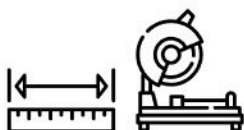

6

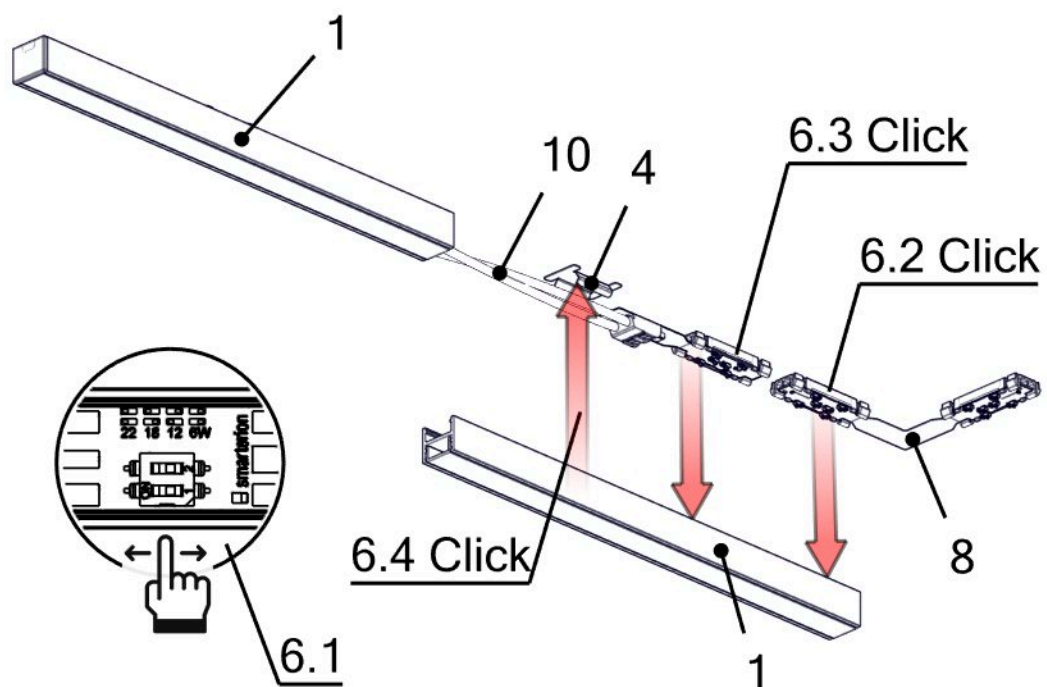

7

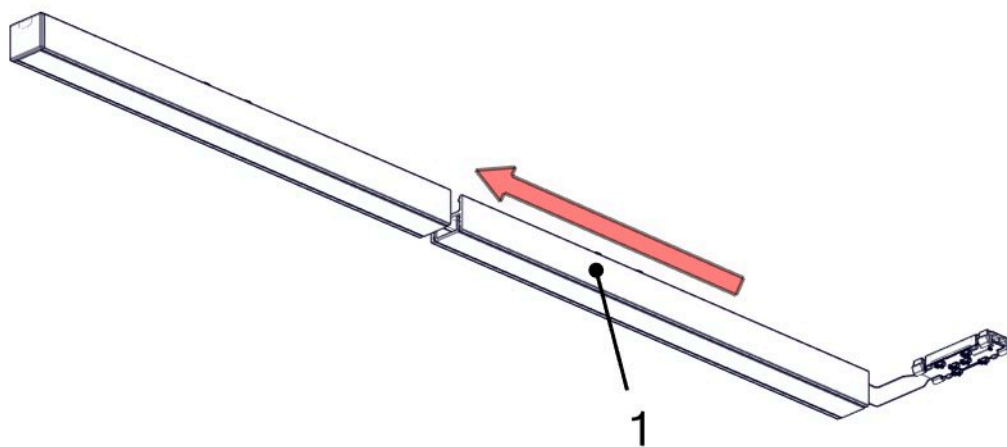

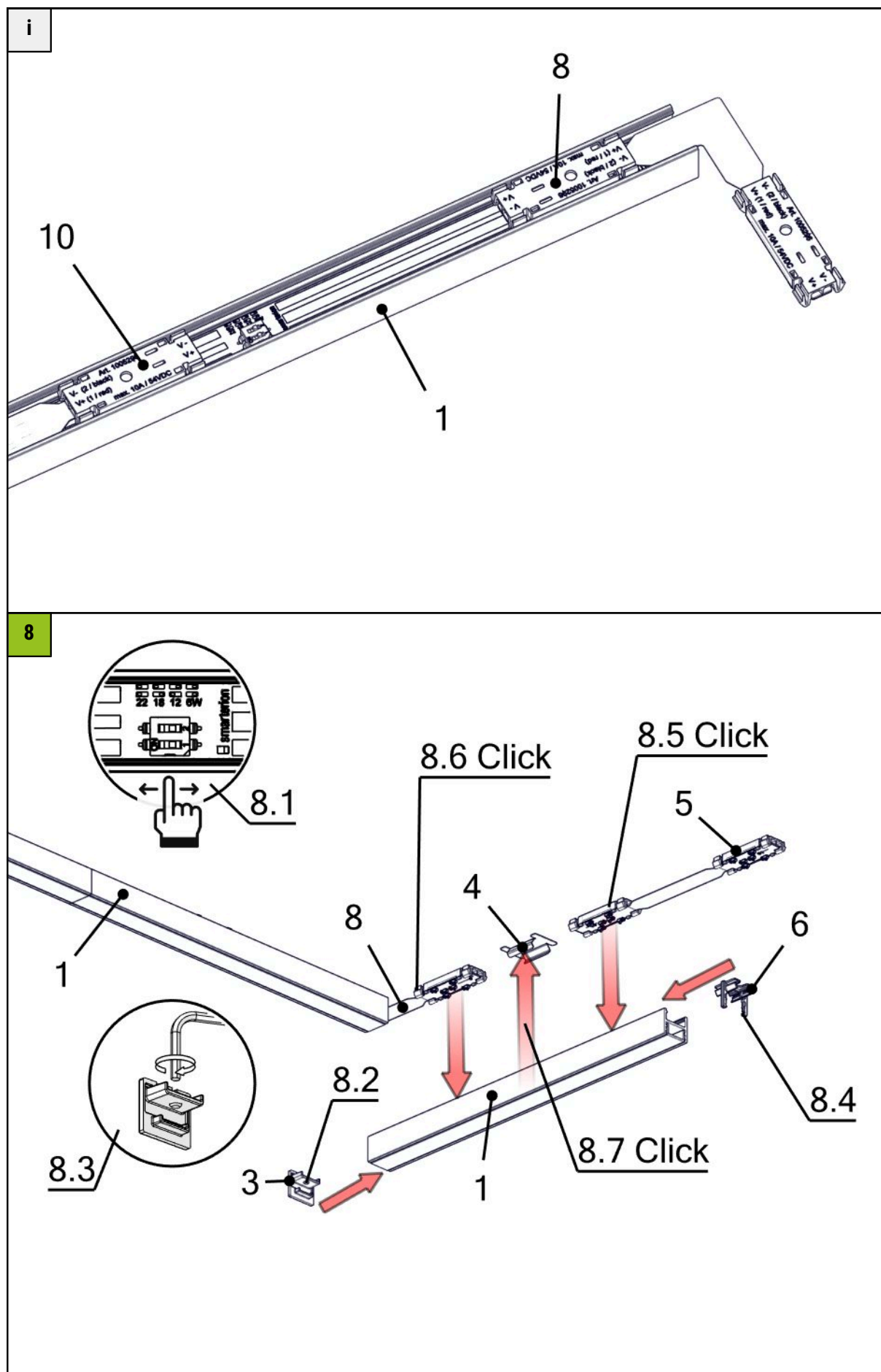

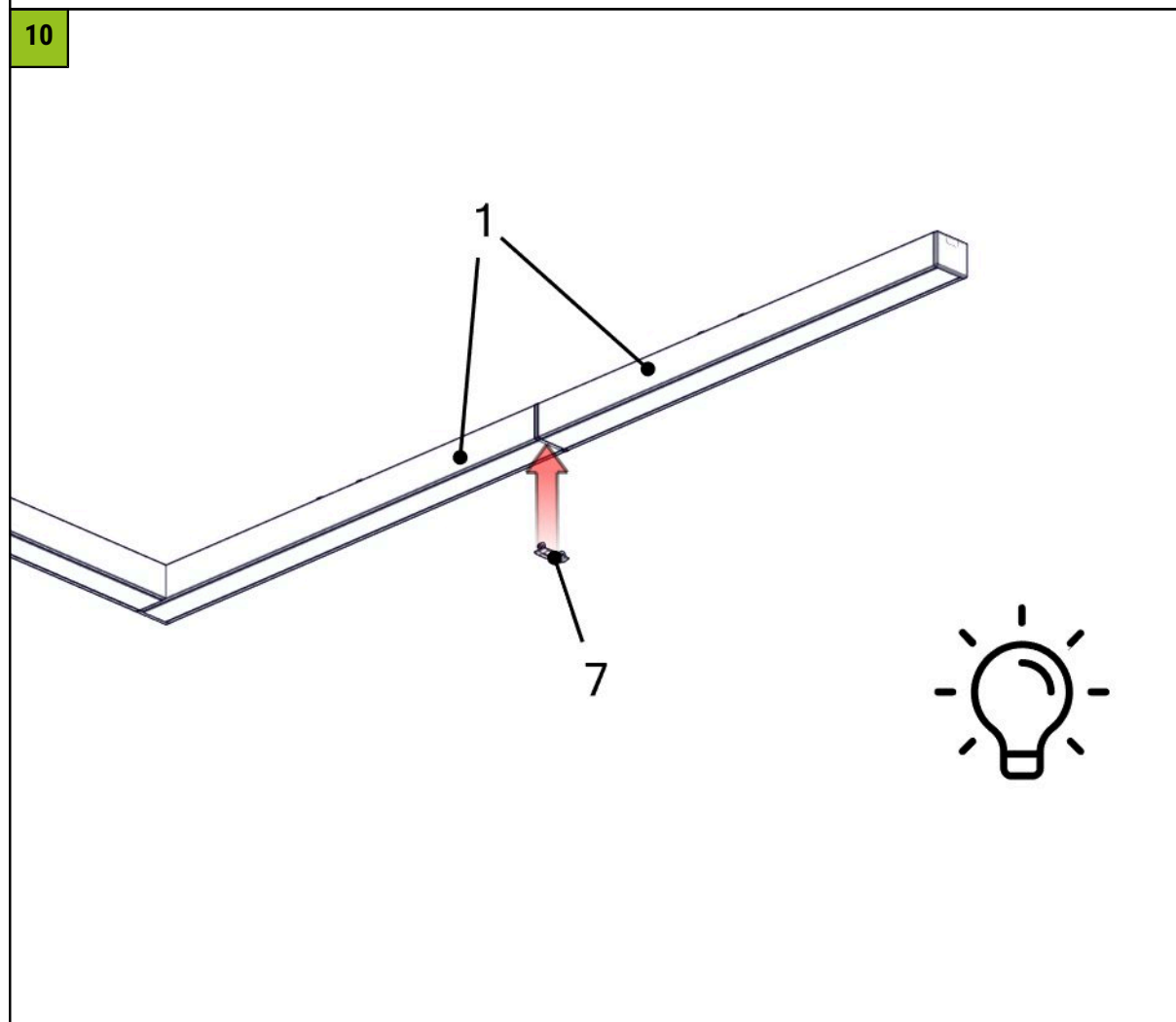
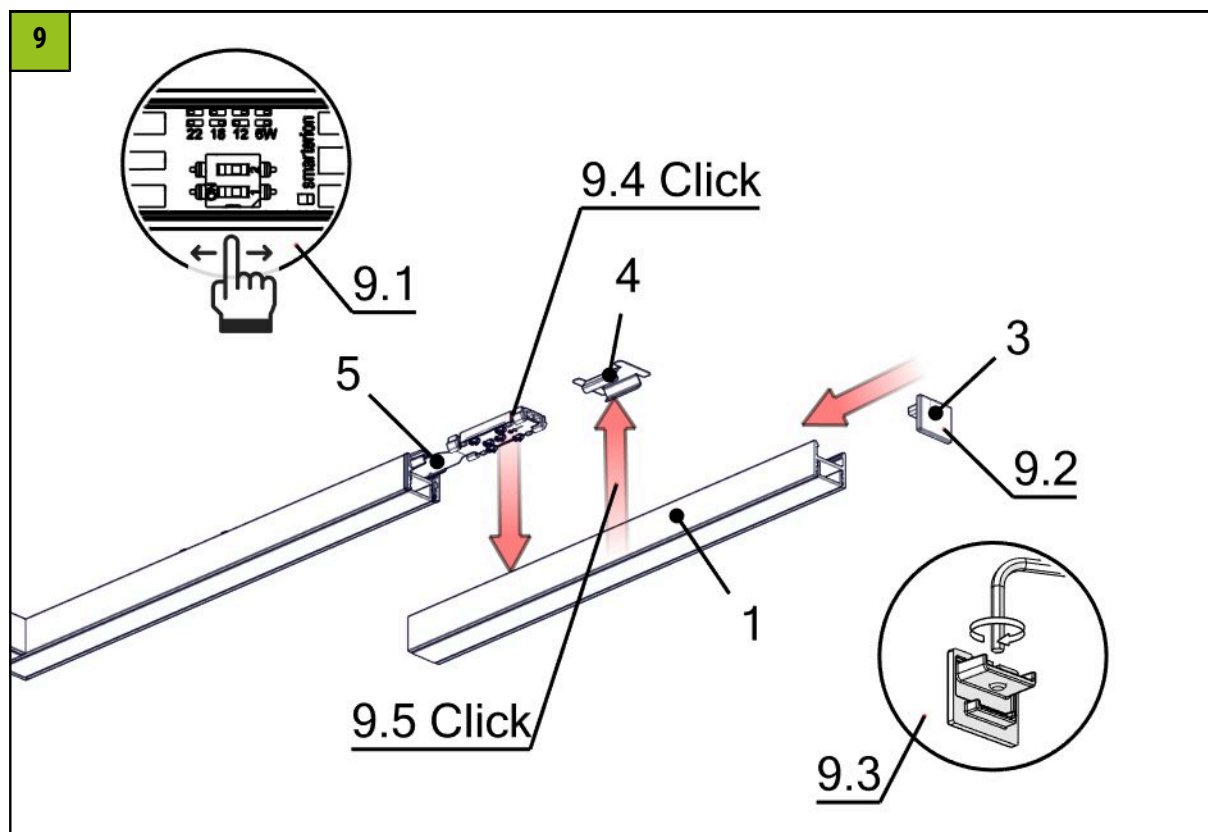

Avvertenze

L'installazione e la messa in funzione devono essere eseguite solo da personale specializzato e autorizzato (elettricista). L'apparecchio viene utilizzato esclusivamente per l'illuminazione e deve essere installato in base alle norme di installazione. Ogni altro uso o installazione è considerato "non conforme all'uso previsto". In caso di mancata osservanza delle istruzioni di installazione, l'apparecchio può essere distrutto. In caso di difetto, restituire al produttore. Le istruzioni di installazione devono essere conservate. Ci riserviamo il diritto di apportare modifiche tecniche! Non può essere montato su superfici umide o conduttive. L'installazione e la messa in funzione dell'apparecchio, come pure eventuali modifiche dell'apparecchio, devono essere eseguite solo da specialisti autorizzati (elettricisti qualificati). Devono essere rispettate le norme nazionali di installazione. L'apparecchio deve essere staccato dalla rete prima di qualunque intervento su di esso. L'inserimento a caldo non è possibile e può causare danni all'apparecchio! Il produttore non è responsabile dei danni derivanti da un'installazione errata, da un funzionamento improprio o da modifiche non autorizzate dell'apparecchio. La lampada di questo apparecchio può essere sostituita solo dal produttore o da un tecnico di servizio da lui incaricato o da una persona altrettanto qualificata. Ci riserviamo il diritto di apportare modifiche tecniche! Se avete delle domande, contattate il produttore.



Scollegare l'apparecchio dalla tensione elettrica.



Attenzione: pericolo di scosse elettriche!

SMALTIMENTO

L'imballaggio deve essere restituito al DSD (Punto Verde). Smaltire l'imballaggio secondo il tipo. I vecchi apparecchi non devono essere smaltiti nei rifiuti domestici. In conformità con le direttive UE, il dispositivo deve essere smaltito correttamente alla fine della sua vita utile. Così facendo, i materiali contenuti nel dispositivo vengono riciclati e si evita l'inquinamento ambientale. Consegnare il vecchio apparecchio in un punto di raccolta di rifiuti elettrici o in un deposito di materiali. Per ulteriori informazioni, contattate la vostra azienda locale di smaltimento dei rifiuti o la vostra amministrazione comunale.

IP20

Protezione contro la penetrazione di corpi estranei solidi di diametro superiore a 12,5 mm.



Apparecchi di classe di protezione III per il funzionamento con bassa tensione di sicurezza (SELV)