



DATA SHEET

Canopies central rope suspension

Different variants of ceiling canopy with integrated converters available.

- Baldachin in der Kombination mit höhenverstellbarer zentraler Seilaufhängung
- Standardaufhängungshöhe: 3m, bis 5m auf Anfrage erhältlich
- Farbe: RAL 9016 weiss matt, weitere RAL Farben auf Anfrage
- Steuerung: Standard DALI, 230V TRIAC-Varianten, Touch-DIM oder Casambi auf Anfrage

6.692 Canopies central rope

Accessories



6.692 Canopies central rope suspension

ART. NO.	DESIGNATION	CHARACTERISTICS		
1006308	Canopy 2x60W with central cable guide	230 VAC INPUT	120 W	DALI CONTROL
1006846	Canopy 1x60W with central cable guide	230 VAC INPUT	60 W	DALI CONTROL
1006841	Canopy 1x100W with central cable guide	230 VAC INPUT	100 W	DALI CONTROL
1006309	Canopy 2x100W with central cable guide	230 VAC INPUT	200 W	DALI CONTROL
1006837	Canopy 1x150W with central cable guide	230 VAC INPUT	150 W	DALI CONTROL
1006310	Canopy 2x150W with central cable guide	230 VAC INPUT	300 W	DALI CONTROL

Technical data

Input voltage	230 V~ 50Hz AC/ DC
---------------	-----------------------

Electrical connection

In

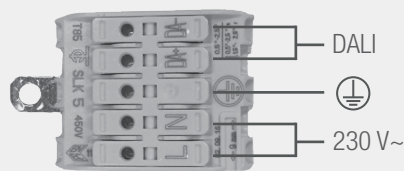

Out

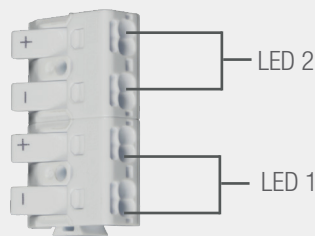

Dimensions

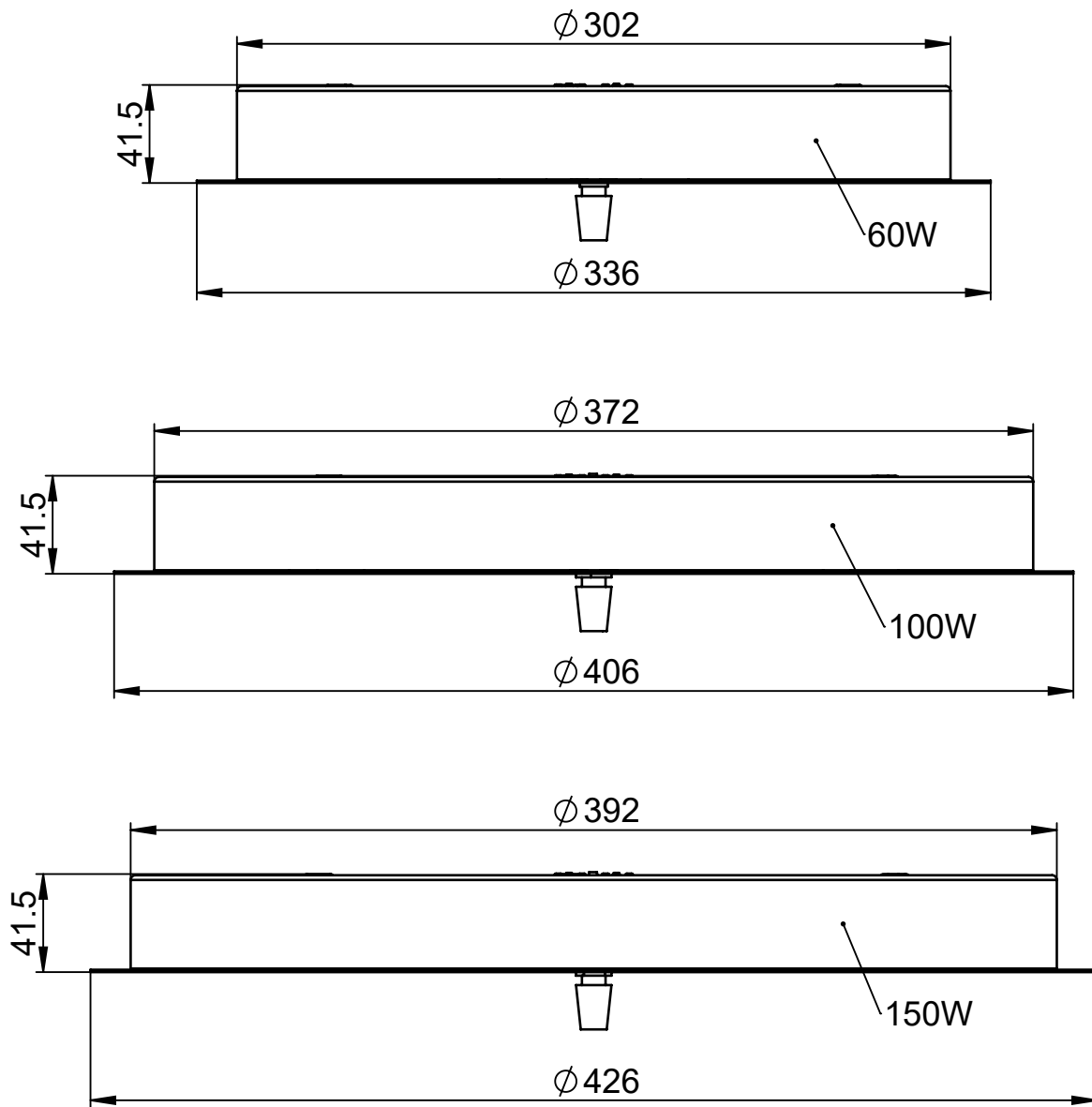

Assembly instructions

Step 1



Step 2

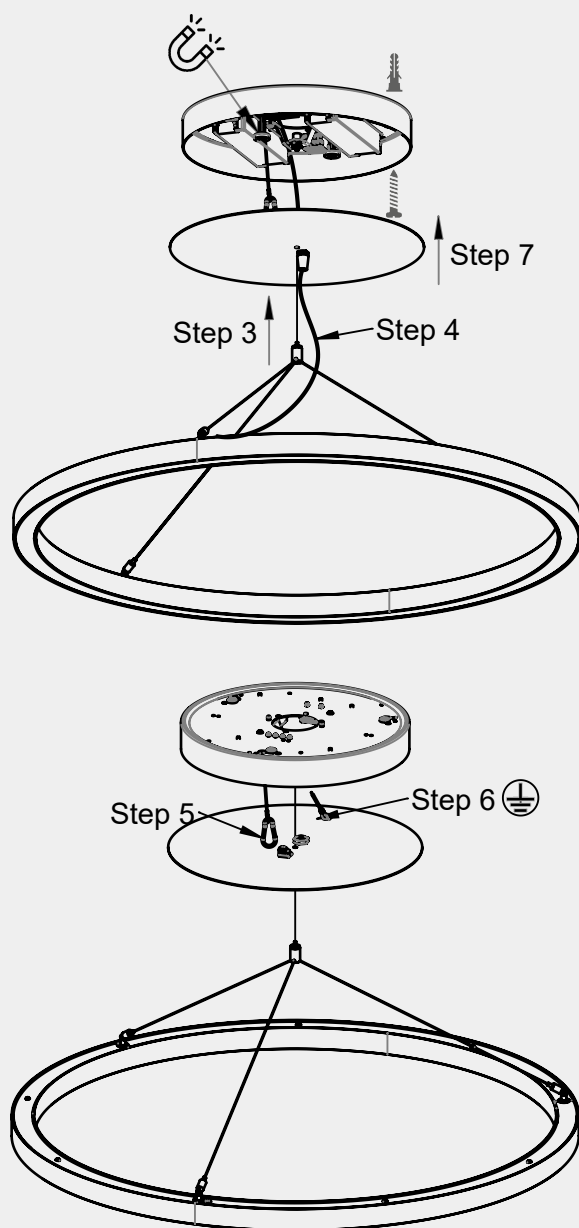

6.692 Canopies central rope suspension

Warnings

The equipment may only be installed and put into service by authorised technical personnel (electrical fitters). The luminaire is designed solely for lighting applications and is to be installed according to the installation regulations. Any other form of use or installation is considered to be improper. Failure to comply with the installation instructions can damage the luminaire beyond repair. Return to the manufacturer if any defects are identified. The installation instructions must be retained for future reference. Subject to technical changes. Not to be installed on a wet or conductive substrate. The luminaire is only to be installed, put into service or modified in any way by authorised skilled personnel (a qualified electrician). National installation regulations must be observed. Before any work is performed on the luminaire, it must be disconnected from mains. Hot plug-in is not an option and may cause damage to the luminaire! The manufacturer is not liable for damage resulting from improper/faulty installation or operation, or from unauthorised modifications to the luminaire. The light source contained in this luminaire is only to be replaced by the manufacturer, a service technician authorised by the manufacturer or a similarly qualified person. Caution, risk of electric shock! In the event of questions or queries, please contact the manufacturer.



Disconnect the luminaire from the power supply.



Caution, risk of electric shock!



DISPOSAL

The packaging must be recycled via the DSD (Green Dot) scheme or its equivalent. Dispose of the packaging correctly sorted. Waste electrical and electronic equipment must never be disposed of together with household waste. In accordance with the EU directives, the device must be disposed of in an orderly manner at the end of its service life. This means having the materials contained in the device recycled to avoid polluting the environment. Take the waste equipment to a collection point for electrical and electronic waste or to a recycling depot. For further information, please contact your local waste disposal service or your local authority.