



## DATA SHEET

# smartUP Outdoor

An elegant, extremely low-profile LED ceiling and wall-mounted luminaire with a minimalist and highly appealing design. The housing is made from impact-resistant white polycarbonate. The high-quality diffuser ensures even and uniform illumination. The luminaire is easy to install. The service life of up to 40,000 hours further accentuates the outstanding performance data boasted by this luminaire. Thanks to its IP54 protection type, the luminaire is perfectly suited to plumbed rooms (e.g. kitchens and bathrooms) and covered outdoor areas.

- Plastic housing, white
- Simple mounting via twist lock catch
- Low construction height from 58 mm
- Service life: 50 000 h LM-80 > 50 000 h
- Elegant, flat, round LED ceiling and wall luminaire
- Optional: emergency lighting module with battery pack
- Protection type: IP54
- Colour temperature adjustable via switch (3000 K / 4000 K / 5700 K)

## SURFACE-MOUNTED LUMINAIRES

### 5.35 smartUP Outdoor

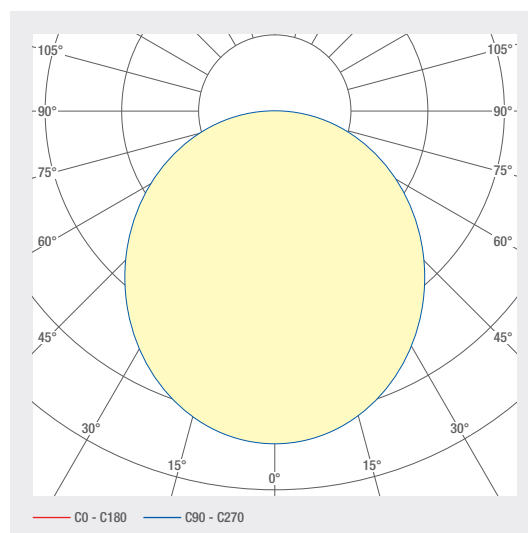
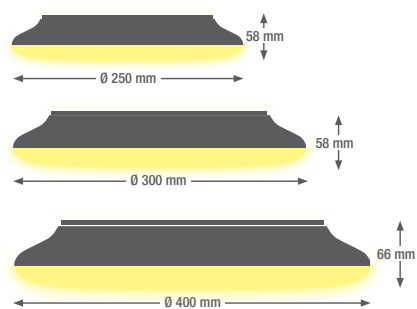

ART. NO.	DESIGNATION	CHARACTERISTICS					
1004458	smartUP 300mm, IP54, white	230 VAC INPUT	18 W	DIFFUSED BEAM	3000 K 4000 K 5700 K	1800 LM	
1004459	smartUP 300mm, IP54, white	230 VAC INPUT	18 W	DIFFUSED BEAM	3000 K 4000 K 5700 K	1800 LM	

## Lighting design

# RELUX®

click on the Relux icon to access our lighting design data directly

## Technical data

Storage temperature	-30 ... +40 °C
Max. surface temperature	65 °C
Shock rating	IK10
Protection type (IP)	IP54
Ambient temperature ta	25 °C
Service life L80B10 (h) @ ta = 25°C	50000 h



- |                                      |   |
|--------------------------------------|---|
| 1 Product description                | 7 Item number                           |
| 2 Color temperature, e.g. 3000K      | 8 QR code with unique identification ID |
| 3 Color rendering index, e.g. 90 CRI | 9 Manufacturer address                  |
| 4 Voltage, e.g. 230 V ~              |   |
| 5 Power, e.g. 20 W                   |   |
| 6 IP protection, e.g. IP20           |   |

## Electrical connection

ON/OFF



NOT / EMERGENCY



## Dimensions

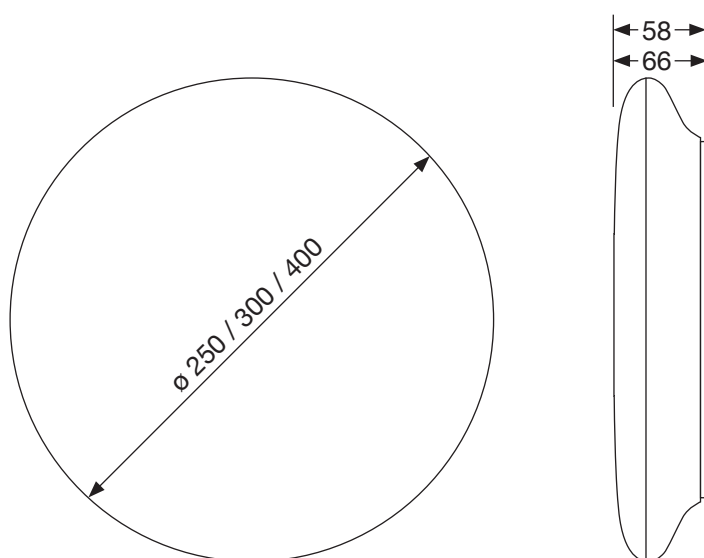

## Assembly instructions

Step 1

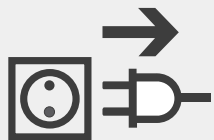

Step 2

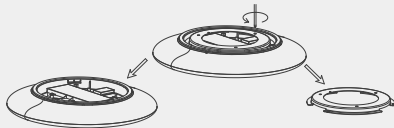

Step 3

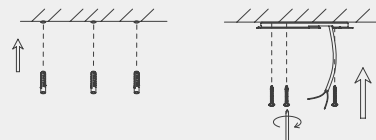

Step 4

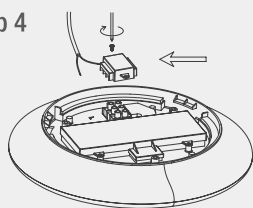

Step 5

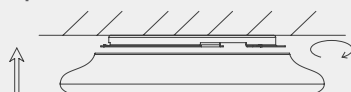

Step 6

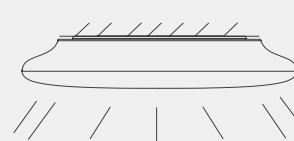

Cleaning and care

Wipe the luminaire clean using a damp, lint-free cloth. Do not scrub! If heavily soiled, wipe clean with a mild solution of warm soapy water (microfibre cloth and washing-up liquid). Do not use a scouring agent. Do not rub the luminaire dry, as the resulting static may damage the electronic components beyond repair.

Warnings

The equipment may only be installed and put into service by authorised technical personnel (electrical fitters). The luminaire is designed solely for lighting applications and is to be installed according to the installation regulations. Any other form of use or installation is considered to be improper. Failure to comply with the installation instructions can damage the luminaire beyond repair. Return to the manufacturer if any defects are identified. The installation instructions must be retained for future reference. Subject to technical changes. Not to be installed on a wet or conductive substrate. The luminaire is only to be installed, put into service or modified in any way by authorised skilled personnel (a qualified electrician). National installation regulations must be observed. Before any work is performed on the luminaire, it must be disconnected from mains. Hot plug-in is not an option and may cause damage to the luminaire! The manufacturer is not liable for damage resulting from improper/faulty installation or operation, or from unauthorised modifications to the luminaire. The light source contained in this luminaire is only to be replaced by the manufacturer, a service technician authorised by the manufacturer or a similarly qualified person. Caution, risk of electric shock! In the event of questions or queries, please contact the manufacturer.



Disconnect the luminaire from the power supply.



Caution, risk of electric shock!



**DISPOSAL**  
The packaging must be recycled via the DSD (Green Dot) scheme or its equivalent. Dispose of the packaging correctly sorted. Waste electrical and electronic equipment must never be disposed of together with household waste. In accordance with the EU directives, the device must be disposed of in an orderly manner at the end of its service life. This means having the materials contained in the device recycled to avoid polluting the environment. Take the waste equipment to a collection point for electrical and electronic waste or to a recycling depot. For further information, please contact your local waste disposal service or your local authority.

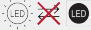

The LED board cannot be replaced due to its design.

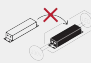

The power supply unit cannot be replaced due to its design.

**IP54**

Dust-tight  
Protected from water spray from any direction.



Protection class II luminaires with double insulation  
Luminaire must not be connected to earth  
Supply cable must be double insulated and strain relief must be correctly installed.