

DATA SHEET

smartROUND Emergency

Round LED insert for refurbishing conventional luminaires (E27, CFL). The LED insert is very easy to install using a magnetic attachment. A very cost-efficient variant if the existing luminaire housing, for example made of glass, is still completely intact.

- Easy mounting and dismounting
- Control gear: can be switched ON/OFF / dimmable: DALI/ Push
- Service life: 50 000 h LM-80 > 50 000 h
- Magnetic mounting
- Other sizes available on request
- Variable mounting options
- No case grounding necessary

3.12 smartROUND Emergency

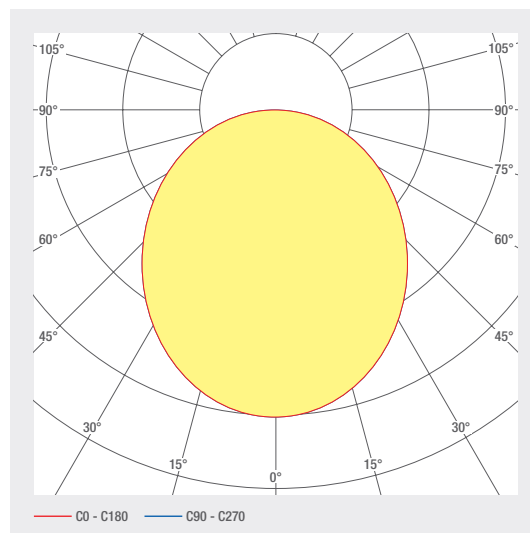
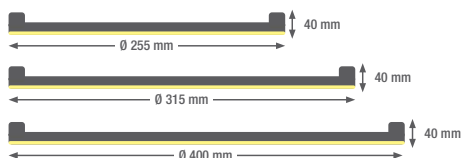
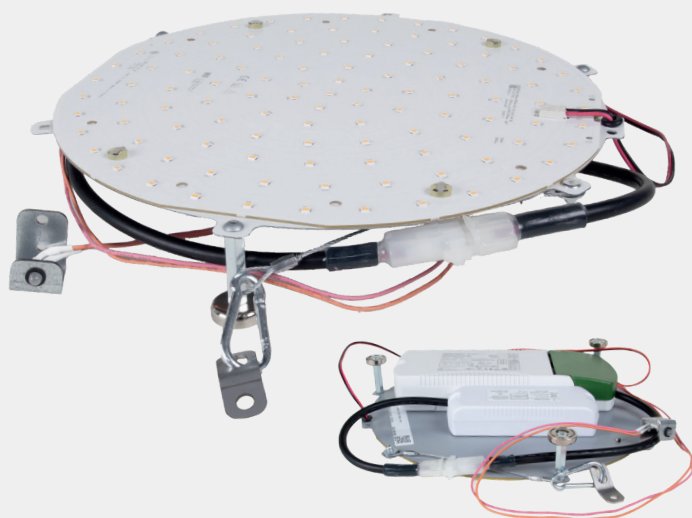

ART. NO.	DESIGNATION	CHARACTERISTICS									
1007363-DN	LED insert 255 R	230 VAC INPUT	21 W	3000 K CRI>80	3460 LM		DALI CONTROL	PUSH CONTROL		SDCM3	
1007363-N	LED insert 255 R	230 VAC INPUT	21 W	3000 K CRI>80	3460 LM			SDCM3			
1007364-DN	LED insert 255 R	230 VAC INPUT	21 W	4000 K CRI>80	3634 LM		DALI CONTROL	PUSH CONTROL		SDCM3	
1007364-N	LED insert 255 R	230 VAC INPUT	21 W	4000 K CRI>80	3634 LM			SDCM3			
1007365-DN	LED insert 315 R	230 VAC INPUT	22 W	3000 K CRI>80	3461 LM		DALI CONTROL	PUSH CONTROL		SDCM3	
1007365-N	LED insert 315 R	230 VAC INPUT	22 W	3000 K CRI>80	3461 LM			SDCM3			
1007366-DN	LED insert 315 R	230 VAC INPUT	22 W	4000 K CRI>80	3749 LM		DALI CONTROL	PUSH CONTROL		SDCM3	
1007366-N	LED insert 315 R	230 VAC INPUT	22 W	4000 K CRI>80	3749 LM			SDCM3			
1007367-DN	LED insert 400 R	230 VAC INPUT	30 W	3000 K CRI>80	4803 LM		DALI CONTROL	PUSH CONTROL		SDCM3	
1007367-N	LED insert 400 R	230 VAC INPUT	30 W	3000 K CRI>80	4803 LM			SDCM3			
1007368-N	LED insert 400 R	230 VAC INPUT	30 W	4000 K CRI>80	5045 LM			SDCM3			
1007368-DN	LED insert 400 R	230 VAC INPUT	30 W	4000 K CRI>80	5045 LM		DALI CONTROL	PUSH CONTROL		SDCM3	

Technical data

Storage temperature	-30 ... +40 °C
Max. surface temperature	65 °C
Shock rating	IK00
Protection type (IP)	IP20
Ambient temperature ta	25 °C
Service life L80B10 (h) @ ta = 25°C	72000 h

1

2

3

4

5

6

7

8

9

LED insert 165 R AC, DALI
3000 K 80 CRI 230 V ~ 50Hz / 12 W / IP 20
Art. Nr. : 1000881

CE smaterion ag, Zeughausstrasse 10, 8887 Mels

209583-01010100

- | | |
|--------------------------------------|---|
| 1 Product description | 7 Item number |
| 2 Color temperature, e.g. 3000K | 8 QR code with unique identification ID |
| 3 Color rendering index, e.g. 80 CRI | 9 Manufacturer address |
| 4 Voltage, e.g. 230 V ~ | |
| 5 Power, e.g. 12 W | |
| 6 IP protection, e.g. IP20 | |

Electrical connection

DALI

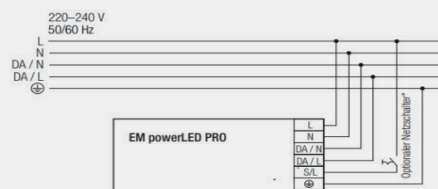

ON/OFF

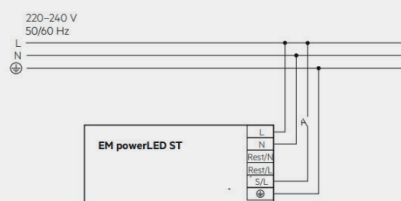

PUSH DIM

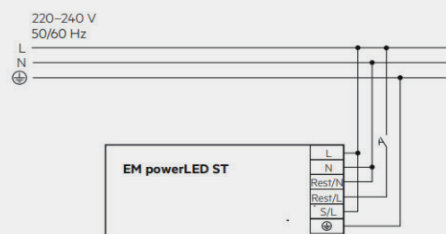

Dimensions

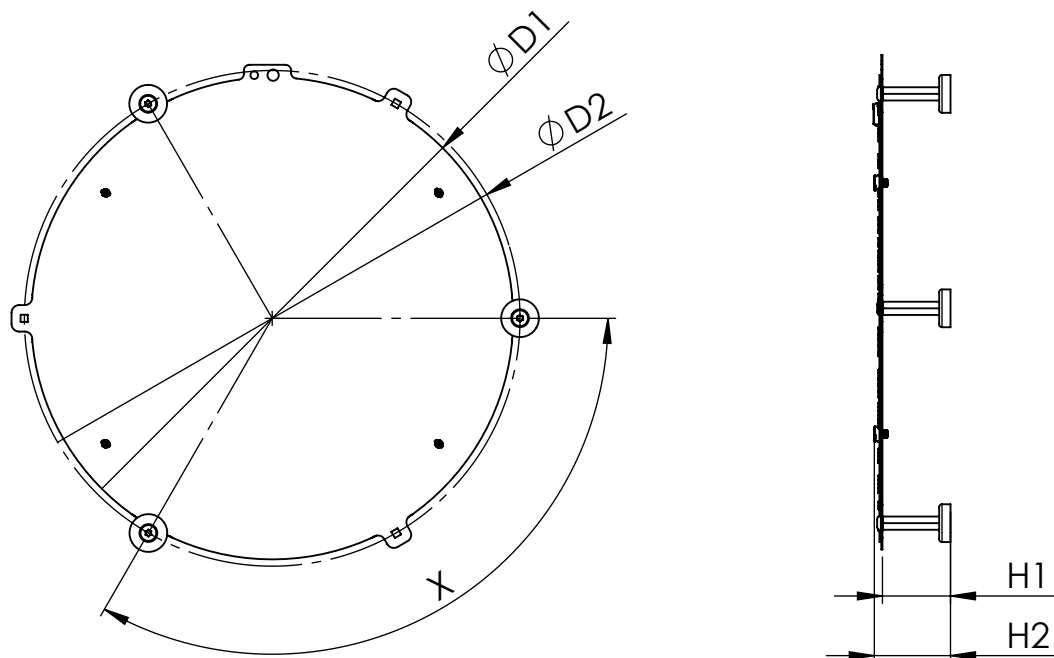

	D1	D2	H1	H2	X
LED-Einsatz 400 R NOT	Ø 400	Ø 408	36	40	3 x 120°
LED-Einsatz 315 R NOT	Ø 315	Ø 322	36	40	3 x 120°
LED-Einsatz 255 R NOT	Ø 255	Ø 262	36	40	3 x 120°

Assembly instructions



Cleaning and care

If, for any reason, the LED modules need to be cleaned, chemicals/solvents or cleaning agents must not be used under any circumstances. To avoid damaging the module, care must be taken not to exert any pressure on the electronic components. For this reason, we recommend the use of dusting brushes or soft cloths.

Warnings

The equipment may only be installed and put into service by authorised technical personnel (electrical fitters). The luminaire is designed solely for lighting applications and is to be installed according to the installation regulations. Any other form of use or installation is considered to be improper. Failure to comply with the installation instructions can damage the luminaire beyond repair. Return to the manufacturer if any defects are identified. The installation instructions must be retained for future reference. Subject to technical changes. Not to be installed on a wet or conductive substrate. The luminaire is only to be installed, put into service or modified in any way by authorised skilled personnel (a qualified electrician). National installation regulations must be observed. Before any work is performed on the luminaire, it must be disconnected from mains. Hot plug-in is not an option and may cause damage to the luminaire! The manufacturer is not liable for damage resulting from improper/faulty installation or operation, or from unauthorised modifications to the luminaire. The light source contained in this luminaire is only to be replaced by the manufacturer, a service technician authorised by the manufacturer or a similarly qualified person. Caution, risk of electric shock! In the event of questions or queries, please contact the manufacturer.



Disconnect the luminaire from the power supply.



Caution, risk of electric shock!



DISPOSAL

The packaging must be recycled via the DSD (Green Dot) scheme or its equivalent. Dispose of the packaging correctly sorted. Waste electrical and electronic equipment must never be disposed of together with household waste. In accordance with the EU directives, the device must be disposed of in an orderly manner at the end of its service life. This means having the materials contained in the device recycled to avoid polluting the environment. Take the waste equipment to a collection point for electrical and electronic waste or to a recycling depot. For further information, please contact your local waste disposal service or your local authority.



The LED board(s) can only be replaced by smarterion as the manufacturer. Please do not attempt to replace the components yourself, as this will void the warranty and CE conformity.



The power supply can only be replaced by smarterion as the manufacturer. Please do not attempt to replace the components yourself, as this will void the warranty and CE conformity.



LED can afterglow if the metal back plate is earthed. Therefore, always mount on the supplied spacer feet or insulate against an earthed outer housing to ensure that no afterglow occurs.

IP20

Protected against ingress of solid foreign objects with a diameter of more than 12.5 mm.



Protection class II luminaires with double insulation

Luminaire must not be connected to earth

Supply cable must be double insulated and strain relief must be correctly installed.

**DALI
CONTROL**

The luminaire is dimmable by DALI. Please observe the DALI specifications. The DALI cable must meet the specification of a mains cable: 230V