



DATA SHEET

smartLED 1416

An elegant high-quality LED light line made from anodised aluminium that meets the highest demands. Thanks to its variable length, the light line can be used as a single luminaire or as a strip light. As a result, fully uniform illumination is ensured from end to end.

- Anodised aluminium channel
- Definable cable tap
- Opal PC cover for completely uniform illumination
- Die-cast aluminium end caps, painted in profile colour, no visible screws
- Service life: 50 000 h LM-80 > 50'000 h
- Light colors: 2700 K / 3000 K / 4000 K / 6500 K / TW / RGB(W)
- Control gear to be placed externally
- Halogen-free connection cable
- Optional: RAL or NCS powder coating
- Concealed mounting brackets





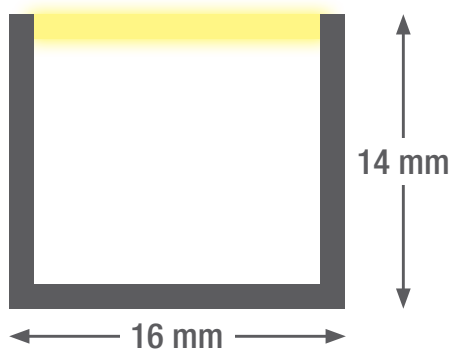
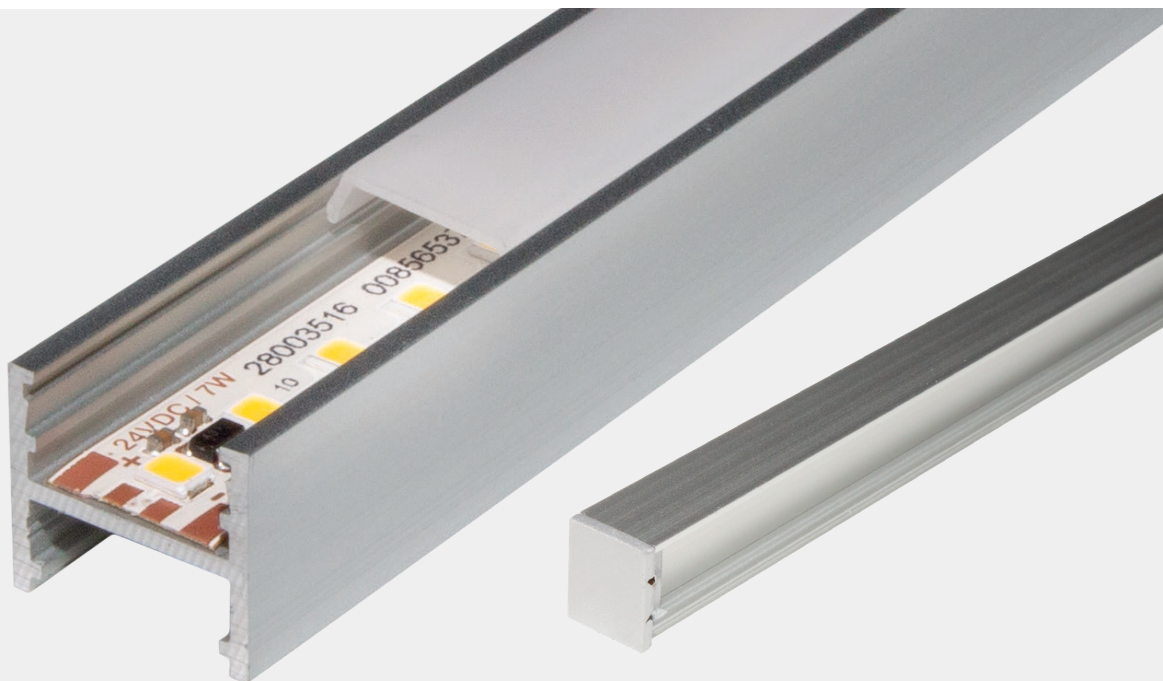

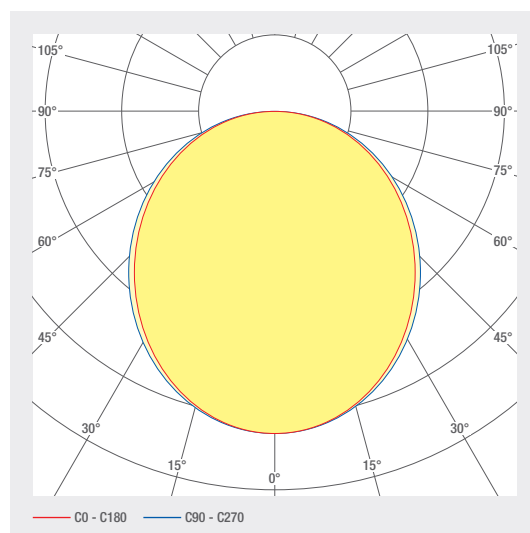

LED SYSTEMS

1.101 smartLED 1416



Profile length up to 5 m one-piece, greater than 5 m multi-piece



ART. NO.	DESIGNATION	CHARACTERISTICS									
1005961	smartLED 1416	24 V DC INPUT	25.8 W/M	DIFFUSED BEAM	RGB	120 LED/M					
1005964	smartLED 1416	24 V DC INPUT	19.2 W/M	DIFFUSED BEAM	RGBW 6500 K	98 LED/M					
1005962	smartLED 1416	24 V DC INPUT	19.2 W/M	DIFFUSED BEAM	RGBW 8000 K	98 LED/M					
1005963	smartLED 1416	24 V DC INPUT	19.2 W/M	DIFFUSED BEAM	RGBWW 3000 K	98 LED/M					
1005910	smartLED 1416	24 V DC INPUT	22 W/M	DIFFUSED BEAM	2700 K CRI>80	133 LED/M	2037 LM/M		SDCM3		
1005901	smartLED 1416	24 V DC INPUT	12 W/M	DIFFUSED BEAM	2700 K CRI>80	133 LED/M	1076 LM/M		SDCM3		
1005907	smartLED 1416	24 V DC INPUT	18 W/M	DIFFUSED BEAM	2700 K CRI>80	133 LED/M	1632 LM/M		SDCM3		
1005904	smartLED 1416	24 V DC INPUT	7 W/M	DIFFUSED BEAM	2700 K CRI>80	133 LED/M	673 LM/M		SDCM3		
1005908	smartLED 1416	24 V DC INPUT	18 W/M	DIFFUSED BEAM	3000 K CRI>80	133 LED/M	1691 LM/M		SDCM3		
1005905	smartLED 1416	24 V DC INPUT	7 W/M	DIFFUSED BEAM	3000 K CRI>80	133 LED/M	697 LM/M		SDCM3		
1005911	smartLED 1416	24 V DC INPUT	22 W/M	DIFFUSED BEAM	3000 K CRI>80	133 LED/M	2111 LM/M		SDCM3		
1005902	smartLED 1416	24 V DC INPUT	12 W/M	DIFFUSED BEAM	3000 K CRI>80	133 LED/M	1116 LM/M		SDCM3		
1005903	smartLED 1416	24 V DC INPUT	12 W/M	DIFFUSED BEAM	4000 K CRI>80	133 LED/M	1185 LM/M		SDCM3		
1005909	smartLED 1416	24 V DC INPUT	18 W/M	DIFFUSED BEAM	4000 K CRI>80	133 LED/M	1797 LM/M		SDCM3		
1005912	smartLED 1416	24 V DC INPUT	22 W/M	DIFFUSED BEAM	4000 K CRI>80	133 LED/M	2243 LM/M		SDCM3		
1005906	smartLED 1416	24 V DC INPUT	7 W/M	DIFFUSED BEAM	4000 K CRI>80	133 LED/M	741 LM/M		SDCM3		
1006434	smartLED 1416	24 V DC INPUT	18 W/M	DIFFUSED BEAM	2700 - 6500 K CRI>80	120 LED/M	1288 LM/M		SDCM3		
1005889	smartLED 1416	24 V DC INPUT	12 W/M	DIFFUSED BEAM	2700 K CRI>90	133 LED/M	928 LM/M		SDCM3		
1005898	smartLED 1416	24 V DC INPUT	22 W/M	DIFFUSED BEAM	2700 K CRI>90	133 LED/M	1757 LM/M		SDCM3		
1005895	smartLED 1416	24 V DC INPUT	18 W/M	DIFFUSED BEAM	2700 K CRI>90	133 LED/M	1407 LM/M		SDCM3		
1005892	smartLED 1416	24 V DC INPUT	7 W/M	DIFFUSED BEAM	2700 K CRI>90	133 LED/M	580 LM/M		SDCM3		
1005896	smartLED 1416	24 V DC INPUT	18 W/M	DIFFUSED BEAM	3000 K CRI>90	133 LED/M	1443 LM/M		SDCM3		
1005899	smartLED 1416	24 V DC INPUT	22 W/M	DIFFUSED BEAM	3000 K CRI>90	133 LED/M	1801 LM/M		SDCM3		
1005893	smartLED 1416	24 V DC INPUT	7 W/M	DIFFUSED BEAM	3000 K CRI>90	133 LED/M	595 LM/M		SDCM3		
1005890	smartLED 1416	24 V DC INPUT	12 W/M	DIFFUSED BEAM	3000 K CRI>90	133 LED/M	952 LM/M		SDCM3		
1005891	smartLED 1416	24 V DC INPUT	12 W/M	DIFFUSED BEAM	4000 K CRI>90	133 LED/M	996 LM/M		SDCM3		
1005900	smartLED 1416	24 V DC INPUT	22 W/M	DIFFUSED BEAM	4000 K CRI>90	133 LED/M	1886 LM/M		SDCM3		

LED SYSTEMS

1.101 smartLED 1416

ART. NO.	DESIGNATION	CHARACTERISTICS							
1005894	smartLED 1416	24 V DC INPUT	7 W/M	DIFFUSED BEAM	4000 K CRI>90	133 LED/M	623 LM/M	E A G	SDCM3
1005897	smartLED 1416	24 V DC INPUT	18 W/M	DIFFUSED BEAM	4000 K CRI>90	133 LED/M	1510 LM/M	E A G	SDCM3

Lighting design

RELUX®

click on the Relux icon to access our lighting design data directly

Accessories

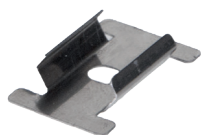

Art. No.
1006975



Art. No.
1006880



Art. No.
1005713



Art. No.
1005874



Art. No.
1006313





Art. No.
1006314

ART. NO.	DESIGNATION
1002358	Opal encapsulation, IP68
2002095	IP65 protective coating
1006975	Mounting bracket
1006880	smartCONN connection connector straight
1005713	smartCONN connector to power supply 90°
1005874	smartCONN flat conductor through-wiring
1006313	smartCONN linear connector
1006314	smartCONN edge connector 90°

Technical data

Storage temperature	-25 ... +50 °C
Max. surface temperature	75 °C
Shock rating	IK06
Protection type (IP)	IP20
Ambient temperature t_a	25 °C
Service life L80B10 (h) @ $t_a = 25^\circ\text{C}$	50000 h

1 kitchen ground floor **7** **8** **9**
5 smartLED 1919 45° / 11W/m / 2700K / IP20 **11**
4 Art. Nr. : 1000881 **6** 24V **2**
3 Länge: 2800 mm **10** smaterion ag, Zeughausstrasse 10, 8887 Mels
2 Länge tot: 11000 mm **1/2**

CE  

209583-01010100

- 1** Position, e.g. kitchen
- 2** Profile part for multi-part lengths, e.g. $\frac{1}{3}$, $\frac{2}{3}$, $\frac{3}{3}$
- 3** Length profile
- 4** Item number
- 5** Profile type, e.g. smartLED 1216
- 6** Voltage, e.g. 24 V
- 7** Power, e.g. 23W/m
- 8** Color temperature, e.g. 3000K
- 9** IP protection, e.g. IP20
- 10** Manufacturer address
- 11** QR code with unique identification ID

Electrical connection



1: V+
2: V-



1: V+
2: WW(-)
3: CW(-)



1: V+ 3: G(-)
2: B(-) 4: R(-)



1: V+ 4: R(-)
2: B(-) 5: W(-)
3: G(-)

smartCONN System

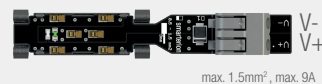

smartWIRE



smartWIRE

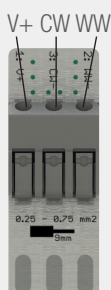

smartWIRE

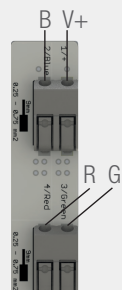

smartWIRE

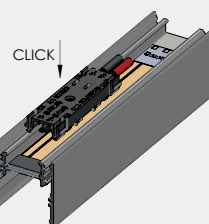
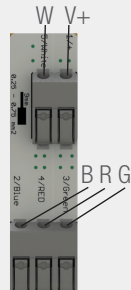

Dimensions

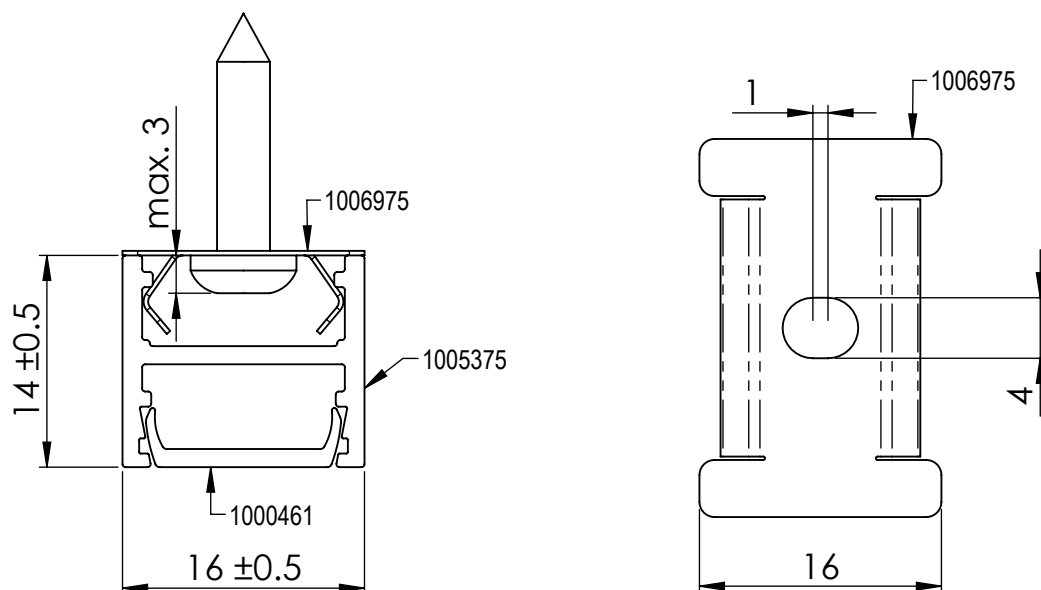

Assembly instructions

Step 1



Step 2

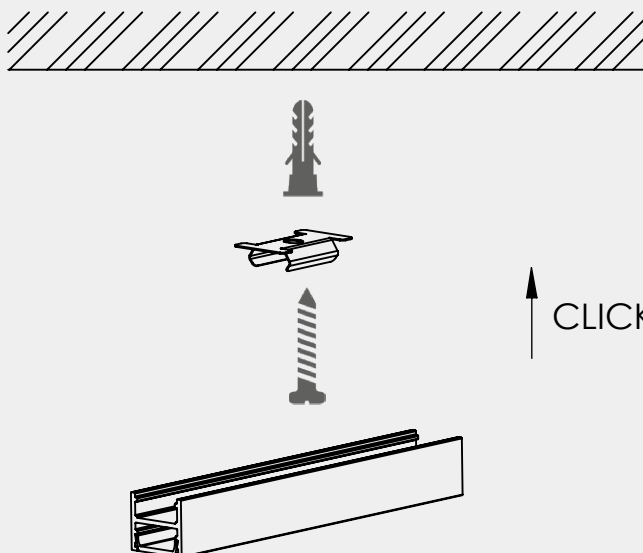
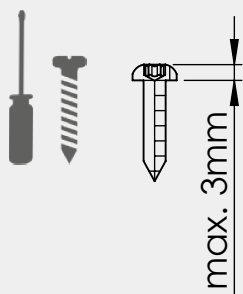

When fitting the clamp, make sure that it can still be turned slightly, otherwise it can cause cracking noises due to thermal expansion.

Cleaning and care

Wipe the luminaire clean using a damp, lint-free cloth. Do not scrub! If heavily soiled, wipe clean with a mild solution of warm soapy water (microfibre cloth and washing-up liquid). Do not use a scouring agent. Do not rub the luminaire dry, as the resulting static may damage the electronic components beyond repair.

Warnings

The equipment may only be installed and put into service by authorised technical personnel (electrical fitters). The luminaire is designed solely for lighting applications and is to be installed according to the installation regulations. Any other form of use or installation is considered to be improper. Failure to comply with the installation instructions can damage the luminaire beyond repair. Return to the manufacturer if any defects are identified. The installation instructions must be retained for future reference. Subject to technical changes. Not to be installed on a wet or conductive substrate. The luminaire is only to be installed, put into service or modified in any way by authorised skilled personnel (a qualified electrician). National installation regulations must be observed. Before any work is performed on the luminaire, it must be disconnected from mains. Hot plug-in is not an option and may cause damage to the luminaire! The manufacturer is not liable for damage resulting from improper/faulty installation or operation, or from unauthorised modifications to the luminaire. The light source contained in this luminaire is only to be replaced by the manufacturer, a service technician authorised by the manufacturer or a similarly qualified person. Caution, risk of electric shock! In the event of questions or queries, please contact the manufacturer.

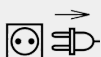

Disconnect the luminaire from the power supply.



Caution, risk of electric shock!



DISPOSAL

The packaging must be recycled via the DSD (Green Dot) scheme or its equivalent. Dispose of the packaging correctly sorted. Waste electrical and electronic equipment must never be disposed of together with household waste. In accordance with the EU directives, the device must be disposed of in an orderly manner at the end of its service life. This means having the materials contained in the device recycled to avoid polluting the environment. Take the waste equipment to a collection point for electrical and electronic waste or to a recycling depot. For further information, please contact your local waste disposal service or your local authority.



The LED board(s) can only be replaced by smarтерion as the manufacturer. Please do not attempt to replace the components yourself, as this will void the warranty and CE conformity.

IP20

Protected against ingress of solid foreign objects with a diameter of more than 12.5 mm.



Class III luminaires for operation at safety extra-low voltage (SELV)