



## DATA SHEET

# smartLED 1216

Elegant, high-quality LED light line made of anodized aluminium that meets the highest demands. Thanks to the variable length, it can be used as a single luminaire or as a strip light, guaranteeing 100% homogeneous illumination over the entire appearance.

- Anodised aluminium channel
- Definable cable tap
- Cover made of opal PMMA for absolutely homogeneous illumination
- End caps made from ABS plastic
- Service life: 50 000 h LM-80 > 50 000 h
- Light colors: 2700 K / 3000 K / 4000 K / 6500 K / TW / RGB(W)
- Control gear to be placed externally
- Halogen-free connection cable
- Optional: RAL or NCS powder coating
- Compact dimensions





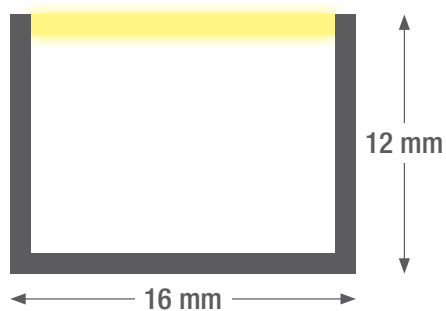
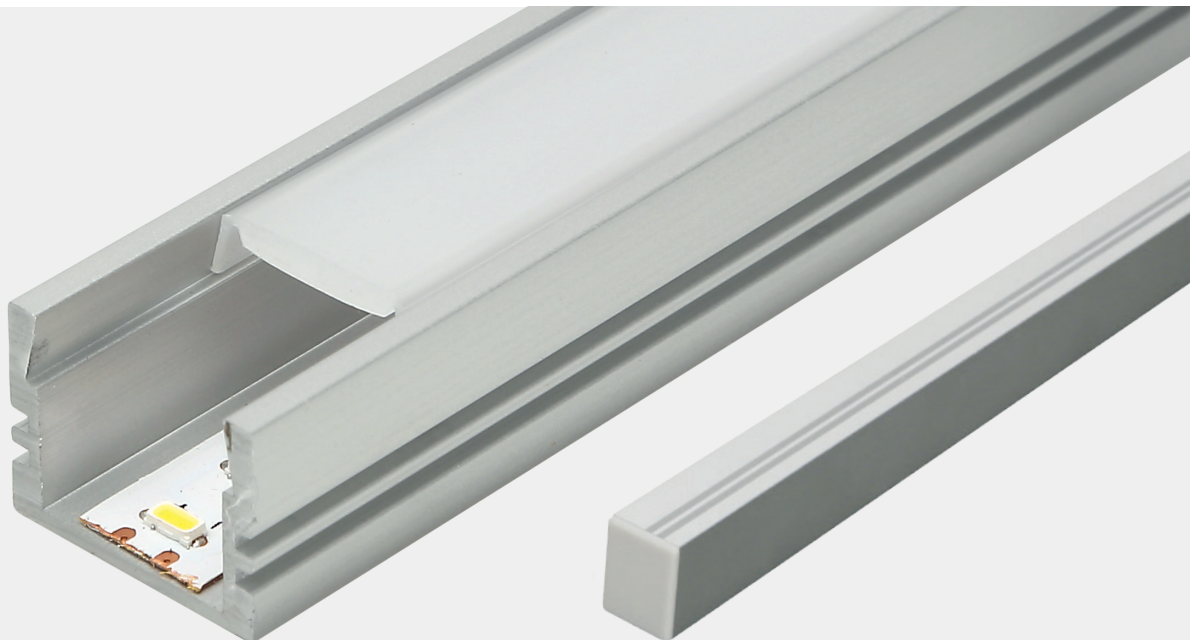

## LED SYSTEMS

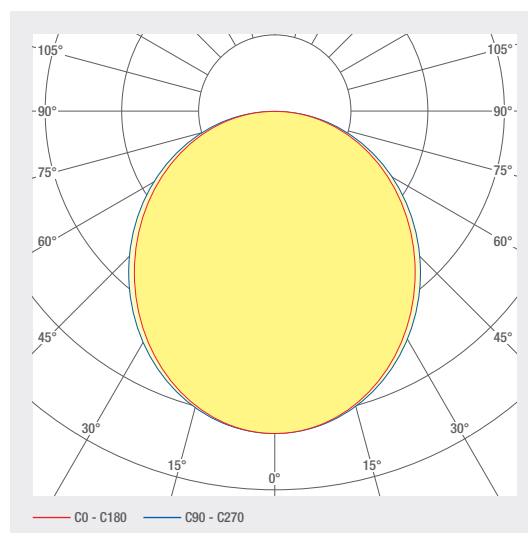
# 1.100 smartLED 1216



Profile length up to 5 m one-piece, greater than 5 m multi-piece



ART. NO.	DESIGNATION	CHARACTERISTICS									
1001374	smartLED 1216	24 V DC INPUT	25.8 W/M	DIFFUSED BEAM	RGB	120 LED/M					
1001482	smartLED 1216	24 V DC INPUT	19.2 W/M	DIFFUSED BEAM	RGBW 6500 K	98 LED/M					
1001390	smartLED 1216	24 V DC INPUT	19.2 W/M	DIFFUSED BEAM	RGBW 8000 K	98 LED/M					
1001426	smartLED 1216	24 V DC INPUT	19.2 W/M	DIFFUSED BEAM	RGBWW 3000 K	98 LED/M					
1002840	smartLED 1216	24 V DC INPUT	22 W/M	DIFFUSED BEAM	2700 K CRI>80	133 LED/M	1710 LM/M		SDCM3		
1002843	smartLED 1216	24 V DC INPUT	12 W/M	DIFFUSED BEAM	2700 K CRI>80	133 LED/M	903 LM/M		SDCM3		
1002844	smartLED 1216	24 V DC INPUT	12 W/M	DIFFUSED BEAM	3000 K CRI>80	133 LED/M	936 LM/M		SDCM3		
1002841	smartLED 1216	24 V DC INPUT	22 W/M	DIFFUSED BEAM	3000 K CRI>80	133 LED/M	1772 LM/M		SDCM3		
1002845	smartLED 1216	24 V DC INPUT	12 W/M	DIFFUSED BEAM	4000 K CRI>80	133 LED/M	994 LM/M		SDCM3		
1002842	smartLED 1216	24 V DC INPUT	22 W/M	DIFFUSED BEAM	4000 K CRI>80	133 LED/M	1883 LM/M		SDCM3		
1000225	smartLED 1216	24 V DC INPUT	12 W/M	DIFFUSED BEAM	2700 K CRI>90	133 LED/M	911 LM/M		SDCM3		
1000241	smartLED 1216	24 V DC INPUT	22 W/M	DIFFUSED BEAM	2700 K CRI>90	133 LED/M	1474 LM/M		SDCM3		
1000242	smartLED 1216	24 V DC INPUT	22 W/M	DIFFUSED BEAM	3000 K CRI>90	133 LED/M	1511 LM/M		SDCM3		
1000239	smartLED 1216	24 V DC INPUT	12 W/M	DIFFUSED BEAM	3000 K CRI>90	133 LED/M	799 LM/M		SDCM3		
1000243	smartLED 1216	24 V DC INPUT	22 W/M	DIFFUSED BEAM	4000 K CRI>90	133 LED/M	1582 LM/M		SDCM3		
1000240	smartLED 1216	24 V DC INPUT	12 W/M	DIFFUSED BEAM	4000 K CRI>90	133 LED/M	836 LM/M		SDCM3		

## Lighting design

# RELUX®

click on the Relux icon to access our lighting design data directly

## LED SYSTEMS

1.100 smartLED 1216

## Accessories



Art. No.  
2002070



Art. No.  
2002060

ART. NO.	DESIGNATION
2002070	Horizontal mounting bracket for smartLED 1216
2002060	90° mounting bracket for smartLED 1216
2002095	IP65 protective coating
2002090	Transparent encapsulation, IP67
1002358	Opal encapsulation, IP68

## Technical data

Storage temperature	-25 ... +50 °C
Max. surface temperature	75 °C
Shock rating	IK03
Protection type (IP)	IP20
Ambient temperature $t_a$	25 °C
Service life L80B10 (h) @ $t_a = 25^\circ\text{C}$	50000 h

1  
5  
4  
CE

**kitchen ground floor**  
**smartLED 1919 45° / 11W/m / 2700K / IP20**  
**Art. Nr. : 1000881**

3  
Länge:  
Länge tot:

7  
8  
9  
6  
24V  
2800 mm  
11000 mm

2  
1/2

11  
10

209583-01010100  
smarterion ag, Zeughausstrasse 10, 8887 Mels

- 1 Position, e.g. kitchen
- 2 Profile part for multi-part lengths, e.g.  $\frac{1}{3}$ ,  $\frac{2}{3}$ ,  $\frac{3}{3}$
- 3 Length profile
- 4 Item number
- 5 Profile type, e.g. smartLED 1216
- 6 Voltage, e.g. 24 V
- 7 Power, e.g. 23W/m
- 8 Color temperature, e.g. 3000K
- 9 IP protection, e.g. IP20
- 10 Manufacturer address
- 11 QR code with unique identification ID

## Electrical connection



1: V+  
2: V-



1: V+  
2: WW(-)  
3: CW(-)



1: V+ 3: G(-)  
2: B(-) 4: R(-)



1: V+ 4: R(-)  
2: B(-) 5: W(-)  
3: G(-)

## Dimensions

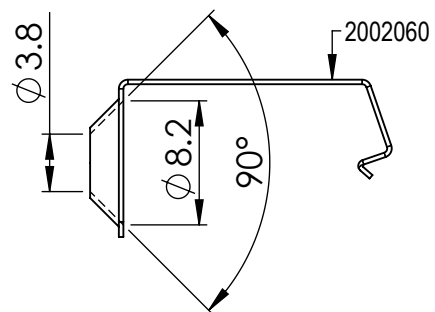
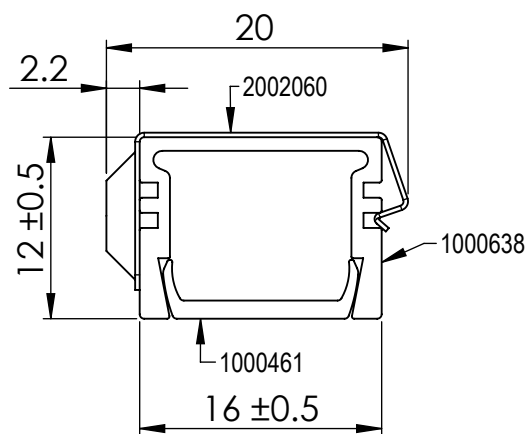
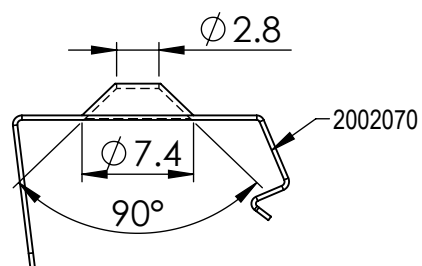
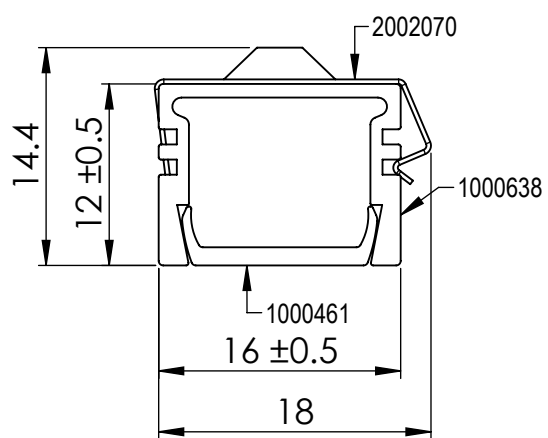

## Assembly instructions

Step 1



Step 2

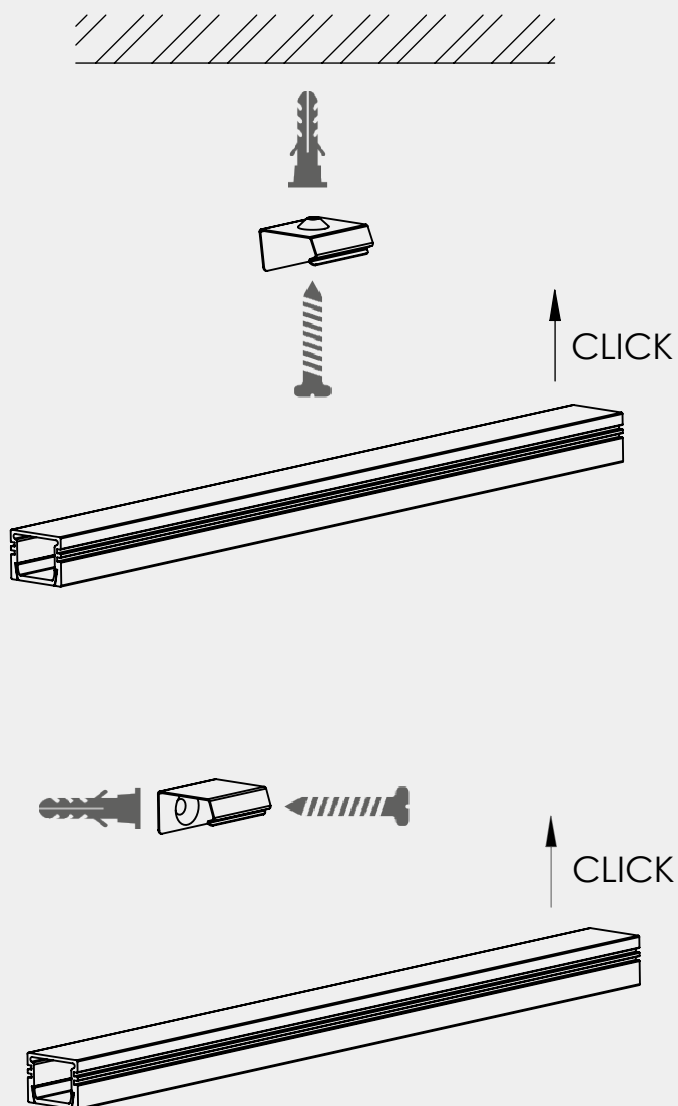

### Cleaning and care

Wipe the luminaire clean using a damp, lint-free cloth. Do not scrub! If heavily soiled, wipe clean with a mild solution of warm soapy water (microfibre cloth and washing-up liquid). Do not use a scouring agent. Do not rub the luminaire dry, as the resulting static may damage the electronic components beyond repair.

### Warnings

The equipment may only be installed and put into service by authorised technical personnel (electrical fitters). The luminaire is designed solely for lighting applications and is to be installed according to the installation regulations. Any other form of use or installation is considered to be improper. Failure to comply with the installation instructions can damage the luminaire beyond repair. Return to the manufacturer if any defects are identified. The installation instructions must be retained for future reference. Subject to technical changes. Not to be installed on a wet or conductive substrate. The luminaire is only to be installed, put into service or modified in any way by authorised skilled personnel (a qualified electrician). National installation regulations must be observed. Before any work is performed on the luminaire, it must be disconnected from mains. Hot plug-in is not an option and may cause damage to the luminaire! The manufacturer is not liable for damage resulting from improper/faulty installation or operation, or from unauthorised modifications to the luminaire. The light source contained in this luminaire is only to be replaced by the manufacturer, a service technician authorised by the manufacturer or a similarly qualified person. Caution, risk of electric shock! In the event of questions or queries, please contact the manufacturer.



Disconnect the luminaire from the power supply.



Caution, risk of electric shock!



#### DISPOSAL

The packaging must be recycled via the DSD (Green Dot) scheme or its equivalent. Dispose of the packaging correctly sorted. Waste electrical and electronic equipment must never be disposed of together with household waste. In accordance with the EU directives, the device must be disposed of in an orderly manner at the end of its service life. This means having the materials contained in the device recycled to avoid polluting the environment. Take the waste equipment to a collection point for electrical and electronic waste or to a recycling depot. For further information, please contact your local waste disposal service or your local authority.



The LED board(s) can only be replaced by smarterion as the manufacturer. Please do not attempt to replace the components yourself, as this will void the warranty and CE conformity.



To avoid danger, only LED converters approved by us are to be used; otherwise, the warranty will be invalidated. Exceptions may be authorised by the manufacturer.

Permitted LED converters:

- Osram, Element
- Mean Well, HLG, LPF
- Tridonic LC

## IP20

Protected against ingress of solid foreign objects with a diameter of more than 12.5 mm.



Class III luminaires for operation at safety extra-low voltage (SELV)